

# DEMA 152

## FAUCET PROPORTIONER

### INSTALLATION INSTRUCTIONS

**1. PARTS:**

ITEM	DESCRIPTION	QTY.
A.	Proportioner Assembly	1
B.	1/4" ID X 8' Long Vinyl Supply Tubing & Foot Valve Assembly	1
C.	Ceramic Weight	1

**2. INSTALLATION:**

Screw proportioner directly onto garden hose type faucets. Remove inlet adapter for mounting onto standard external aerator threads. For other faucets see reverse side for adapter part numbers. For cities with plumbing codes requiring back siphonage protection, install Dema part 34-22 between faucet and proportioner. See Figure 1 for supply tubing attachment.

Cut vinyl tubing to any convenient length, slip on the ceramic weight, and push the open end over the detergent inlet barb. Soften end of tubing in hot water to facilitate attachment. See Section 4 for adjustment screw setting guide.

For filling buckets or mop rinses: a short length of *open ended* garden hose may be attached to the proportioner outlet. Replace screen retainer part 100-8 with hose adapter part 100-10. Use one screen part 100-7 to insure priming.

**3. OPERATION:**

Turn on water and press blue button to draw in chemical. When the water is turned off, the proportioner will reset to dispense clear water.

**4. CHEMICAL PROPORTIONING ADJUSTMENT:**

**WARNING: USE CARE WHEN HANDLING HAZARDOUS CHEMICALS**

The proportion of the detergent or disinfectant to water can be adjusted by turning the recessed screw in the right side of the proportioner. Injection rates for various settings and for products of different viscosities are as follows:

1 cps (centipoise) is equal to the viscosity of water  
 75 cps is approximately equal to the viscosity of 10 weight motor oil  
 200 cps is approximately equal to the viscosity of most dishwashing detergents

Turns Counter-Clockwise from Closed Position	Fluid Ounces Per Gallon of Water		
	Light 1 cps	Medium 75 cps	Heavy 200 cps
1/2	1	0.1	
1	3	0.5	0.2
1 1/2	5	2.0	0.5
2	8	3.5	0.7
4	12	5.0	1.0

**NOTE: The maximum injection rates of very viscous materials can be increased by using oversized tubing Dema part number 100-12L.**

# DEMA 152

## FAUCET PROPORTIONER INSTALLATION INSTRUCTIONS

### 5. **SERVICING:**

**CAUTION: Turn off water supply before servicing.**

#### **A. Failure to inject chemical:**

- a. Low water pressure. At least 10 psi is required.
- b. Dirt or chemical on outlet screens. Clean.
- c. Blue button does not seal when pushed. Remove and inspect for dirt or damage.
- d. Detergent passage blocked. Back off adjusting screw. Remove proportioner and soak in hot water to clean internal passages.
- e. Foot valve clogged. Soak in hot water.
- f. Lime deposits in water passages. Remove proportioner and soak in deliming solution.
- g. Outlet hose (if used) obstructed or too long.

#### **B. Injects continuously:**

- a. Button fails to reset because of damage to button, retainer or spring.
- b. Vacuum breaking air vents in button retainer are clogged with grease or dirt. Clean.
- c. Chemical container above level of faucet. Place container on floor.

**CAUTION: When servicing unit be sure that replacement parts have been installed according to drawing.**

**RETURNS: NO MERCHANDISE MAY BE RETURNED FOR CREDIT WITHOUT DEMA'S WRITTEN PERMISSION. RETURN MERCHANDISE AUTHORIZATION NUMBER REQUIRED IN ADVANCE OF RETURN.**

**WARRANTY:** DEMA products are warranted against defective material and workmanship under normal use and service for one year from the date of manufacture. This limited warranty does not apply to any products which have a normal life shorter than one year or failure and damage caused by chemicals, corrosion, improper voltage supply, physical abuse, or misapplication. Rubber and synthetic rubber parts such as "o"-rings, diaphragms, squeeze tubing and gaskets are considered expendable and are not covered under warranty. This warranty is extended only to the original buyer of DEMA products. If products are altered or repaired without prior approval of DEMA, this warranty will be void.

Defective units or parts should be returned to the factory with transportation prepaid. If inspection shows them to be defective, they will be repaired or replaced without charge, F.O.B. factory. DEMA assumes no liability for damages. Return merchandise authorization number, to return units for repair or replacement, must be granted in advance of return.

# DEMA 152 FAUCET PROPORTIONER INSTALLATION INSTRUCTIONS

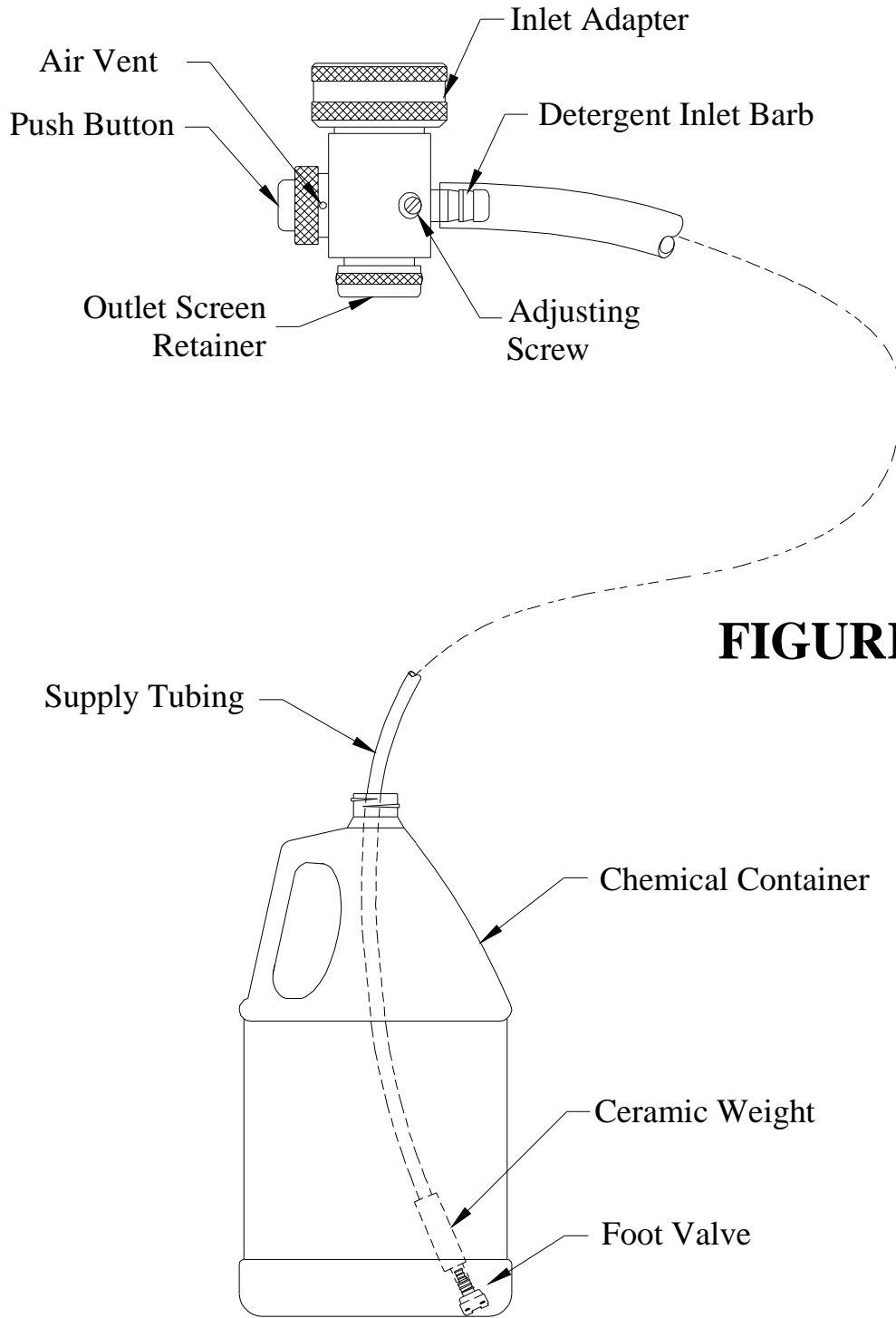
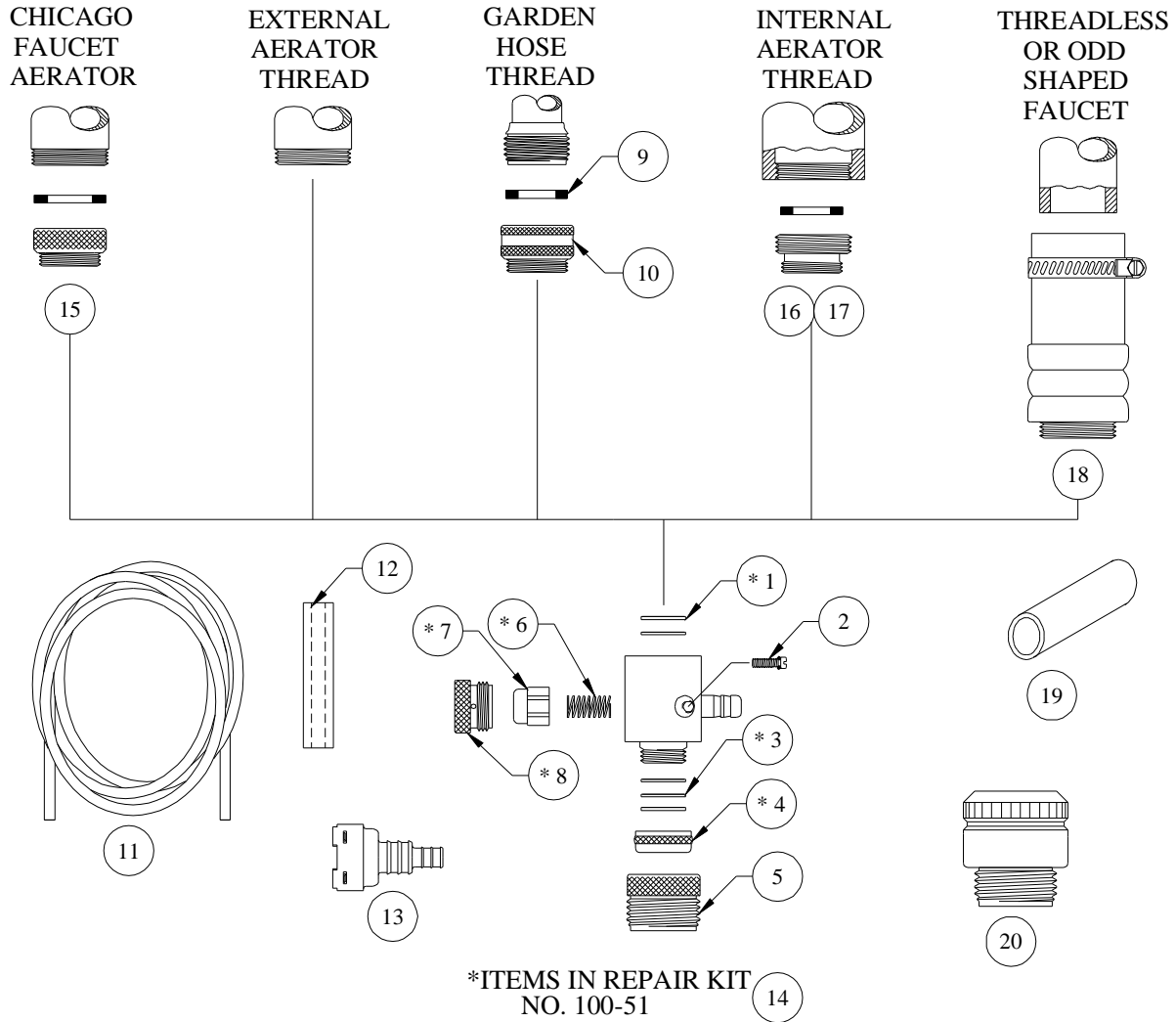

**FIGURE 1**

# DEMA 152

## FAUCET PROPORTIONER

### INSTALLATION INSTRUCTIONS



NO.	PART NO.	DESCRIPTION
1 *	100-6	Inlet Washer (2 Reqd.)
2	100-24	Metering Screw (w/O-Ring)
3 *	100-7	Outlet Screen (3-Reqd.)
4 *	100-8	Outlet Screen Retainer
5	100-10	Outlet Hose Adapter
6 *	100-29	Button Spring
7 *	100-26	Push Button
8 *	100-28	Button Retainer
9	150-6	Adapter Washer
10	150-10	Hose Thread Adapter w/Washer
11	100-12	¼" ID x 8' Lg. Supply Tubing
12	61-107-2	Ceramic Weight

NO.	PART NO.	DESCRIPTION
13	100-16E-1	Foot Valve
14	100-51	Repair Kit

NO.	PART NO.	DESCRIPTION
15	150-23	Outside Chicago Thread Adapter
16	150-21	Inside Aerator Thread Adapter
17	150-32	Inside Kohler Thread Adapter
18	150-9-2	Irregular Faucet Adapter
19	100-14M	Coupling For ¼" ID x 8' Lg. Tubing
20	34-22	Backflow Preventer