

DEMA 951 FLUSH MANIFOLD WITH 24V DC VALVE

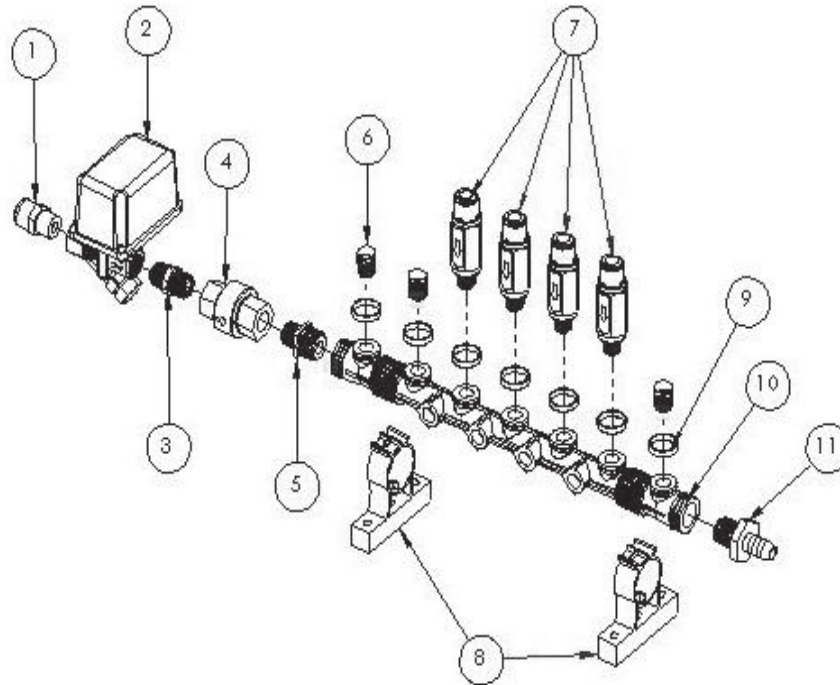

NO.	PART NO.	DESCRIPTION
1	58-103-5	1/4" Push Conn. X 3/8" MNPT
2	95-18-3	442P Valve 24V DC
3	95-24	Polypropylene Hex Nipple
4	95-23	Check Valve
5	95-28	3/8" x 1/2" NPT Reducing Nipple
6	95-27	1/4" NPT Plug
7	95-25-1	3/8" Barb x 1/4" NPT check valve
	95-25-3	3/8" Push x 1/4" NPT check valve
8	95-22	3/4" Clamps
9	29-17-7	Reinforcement Ring
10	95-19	Manifold - Injection Molded
11	66-119-20	1/2" NPT x 1/2" Barb
	58-103-6	1/2" NPT x 3/8" JOHN GUEST Fitting