

DEMA MODEL 691 AND 691T FOAMER INSTALLATION INSTRUCTION

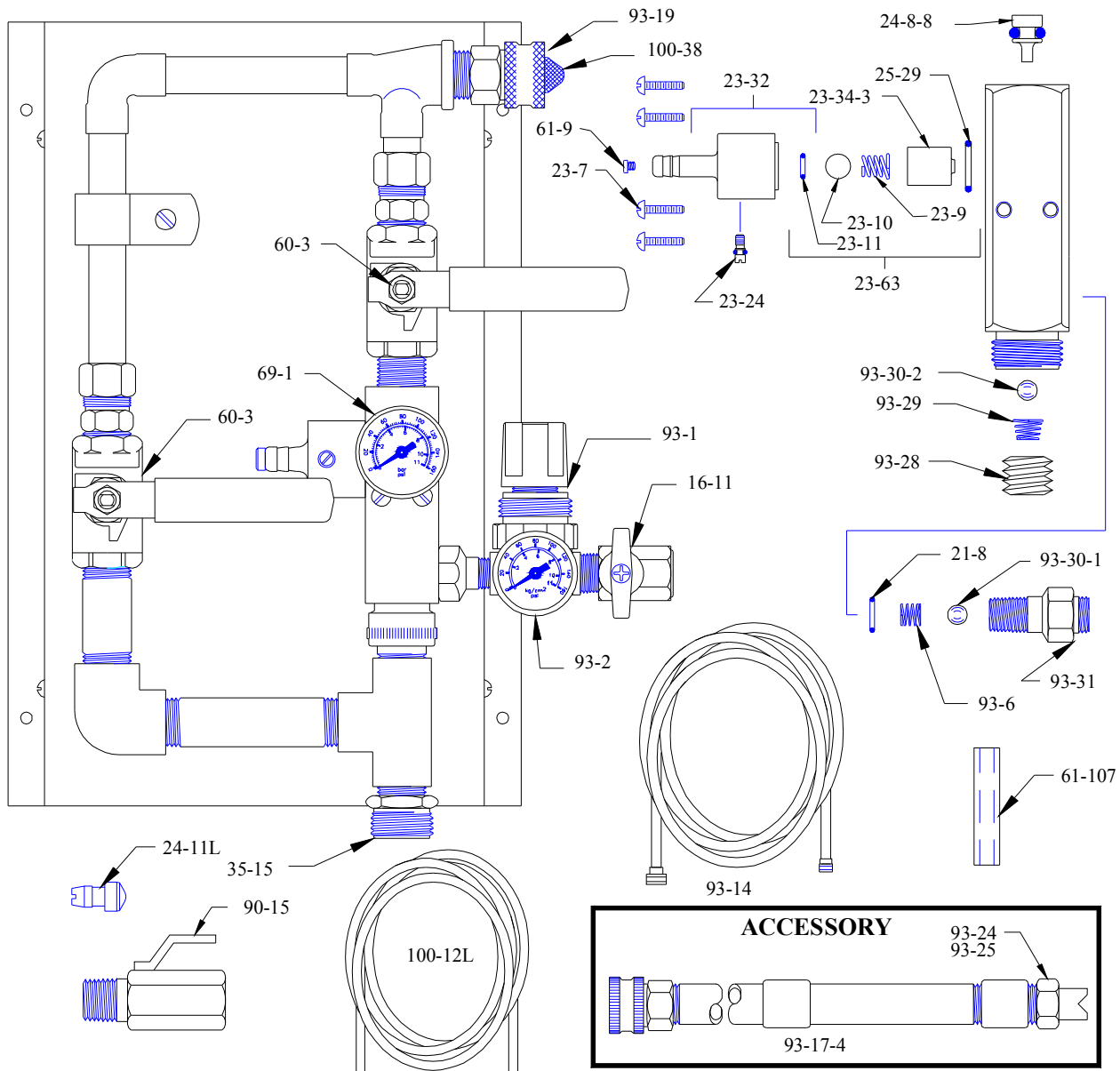

| PART NO. | DESCRIPTION |
|----------|---------------------------------|
| 16-11 | BALL VALVE |
| 21-8 | AIR CHECK VALVE O-RING |
| 23-7 | MACHINE SCREW (4 REQ'D) |
| 23-9 | CHECK VALVE SPRING |
| 23-10 | CHECK VALVE BALL |
| 23-11 | CHECK VALVE O-RING |
| 23-24 | METERING SCREW |
| 23-32 | METERING KNOB W/ METERING SCREW |
| 23-32T | METERING KNOB FOR METERING TIPS |
| 23-34-3 | CHECK VALVE CORE |
| 24-8-8 | WATER NOZZLE WITH O-RING |
| 24-11L | FOOT STRAINER |
| 24-63 | CHECK VALVE REPAIR KIT |
| 25-29 | METERING KNOB O-RING |
| 35-15 | HOSE ADAPTER |
| 60-3 | BALL VALVE |
| 61-9 | METERING TIP (SPECIFY SIZE) |
| 61-107 | CERAMIC WEIGHT |
| 69-1 | WATER PRESSURE GAUGE |
| 93-1 | PRESSURE REGULATOR |

| PART NO. | DESCRIPTION |
|----------|-------------------------|
| 93-2 | PRESSURE GAUGE |
| 93-6 | AIR CHECK VALVE SPRING |
| 93-19 | GARDEN HOSE ADAPTER |
| 93-28 | SPRING RETAINER |
| 93-29 | SPRING |
| 93-30-1 | RUBBER BALL 1/4" DIA |
| 93-31-2 | RUBBER BALL .3125" DIA. |
| 93-31 | AIR INLET ADAPTER |
| 93-32 | FOAMER BODY |
| 100-12L | VINYL TUBING (3/8" ID) |
| 100-38 | STRAINER WASHER |
| 93-32 | FOAMER BODY |

| OPTIONAL ACCESSORIES | |
|----------------------|---|
| 90-15 | OUTLET SHUT OFF VALVE |
| 93-14 | 25' OF 3/4" ID OUTLET HOSE |
| 93-17-4 | 4' LONG SPRAY WAND WITH SOLID STREAM NOZZLE |
| 93-24 | NOZZLE WITH SOLID STREAM |
| 93-25 | NOZZLE WITH 40 ANGLE |