

# DEMA 662-AG AND 662-AG-10H BLEND SAFES

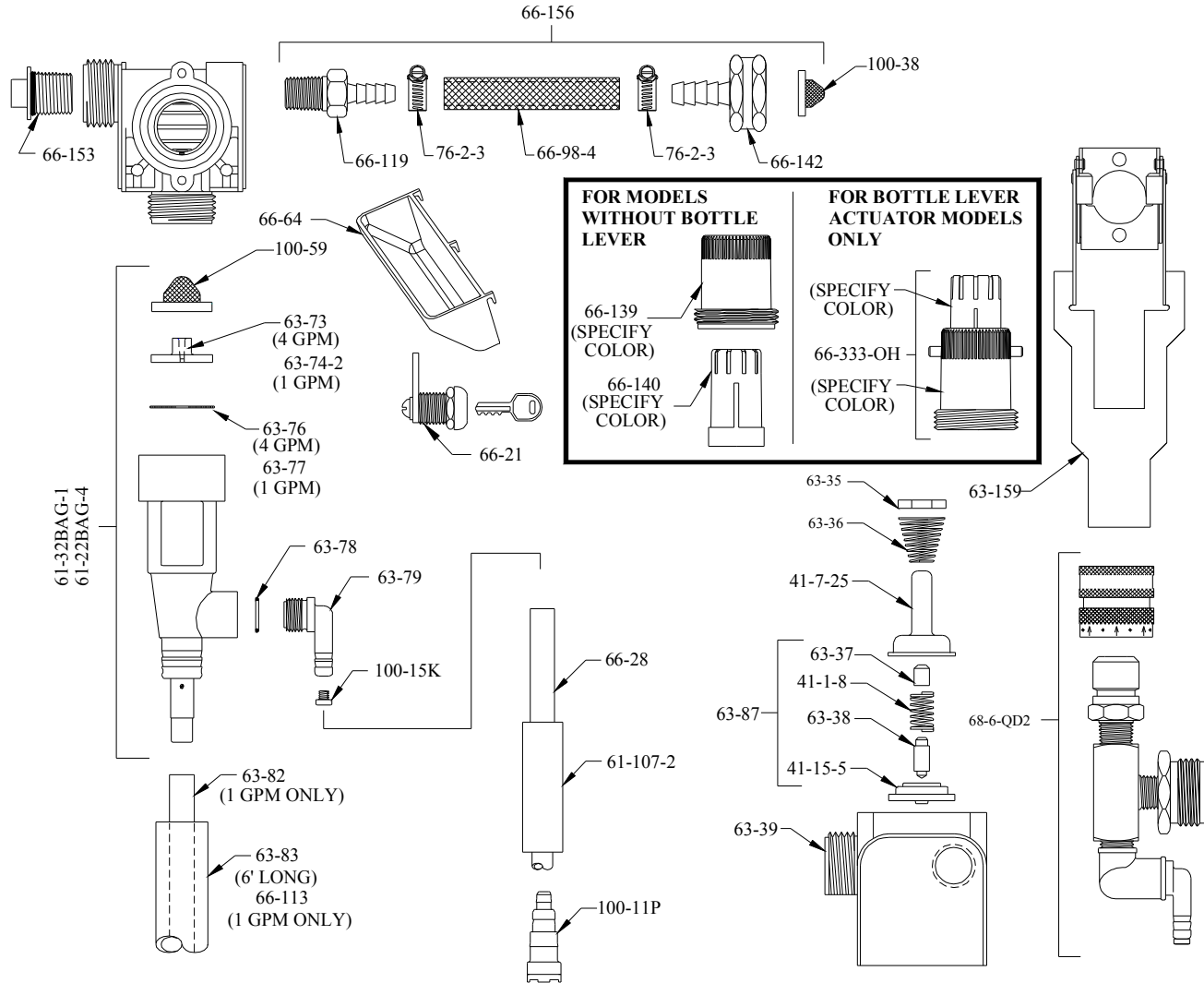

PART NO.	DESCRIPTION
41-1-8	KICK-OFF SPRING
41-7-25	ENCLOSING TUBE
41-15-5	DIAPHRAGM
61-22BAG-4	4 GPM (1/4" BARB) PROPORTIONER
61-32BAG-1	1 GPM (1/4" BARB) PROPORTIONER
61-107-2	CERAMIC WEIGHT
63-35	MAGNET
63-36	SPRING
63-37	SPACER
63-38	PLUNGER
63-39	VALVE BODY
63-73	NOZZLE (4 GPM)
63-74-2	NOZZLE (1 GPM)
63-76	SCREEN (4 GPM)
63-77	SCREEN (1 GPM)
63-78	O-RING
63-79	INLET BARB (1/4" BARB)
63-82	OUTLET TUBE 1/4 ID X 7" (1 GPM ONLY)
63-83	VINYL TUBE (9/16 ID X 6' LG)
63-87	VALVE REPAIR KIT
63-159	BOTTLE LEVER
66-21	CABINET LOCK

PART NO.	DESCRIPTION
66-28	VINYL TUBING
66-64	DRIP TRAY
66-98-4	3/8" BRAIDED TUBING 2.75" LG.
66-113	OUTLET TUBE 9/16" ID X 6.5" (1 GPM ONLY)
66-119	HOSE BARB
66-139	MAGNET HOUSING (SPECIFY COLOR)
66-140	PUSH BUTTON (SPECIFY COLOR)
66-142	FEMALE GHT SWIVEL COUPLING
66-153	PIPE PLUG & O-RING ASSY.
66-156	WATER INLET ASSEMBLY
66-333-OH	PUSH BUTTON KIT
76-2-3	WORM HOSE CLAMP (2 EA)
100-11P	FOOT VALVE
100-15K	METERING TIP KIT-14 SIZES
100-38	STRAINER WASHER
100-59	STRAINER WASHER
163AG	4 GPM AIR GAP PRPORTIONER
164AG	1 GPM AIR GAP PRPORTIONER

ACCESSORIES	
PART NO.	DESCRIPTION
68-6-QD2	PRESSURE INDICATING TEE