

BLEND SAFE MODEL: 662-GAPB

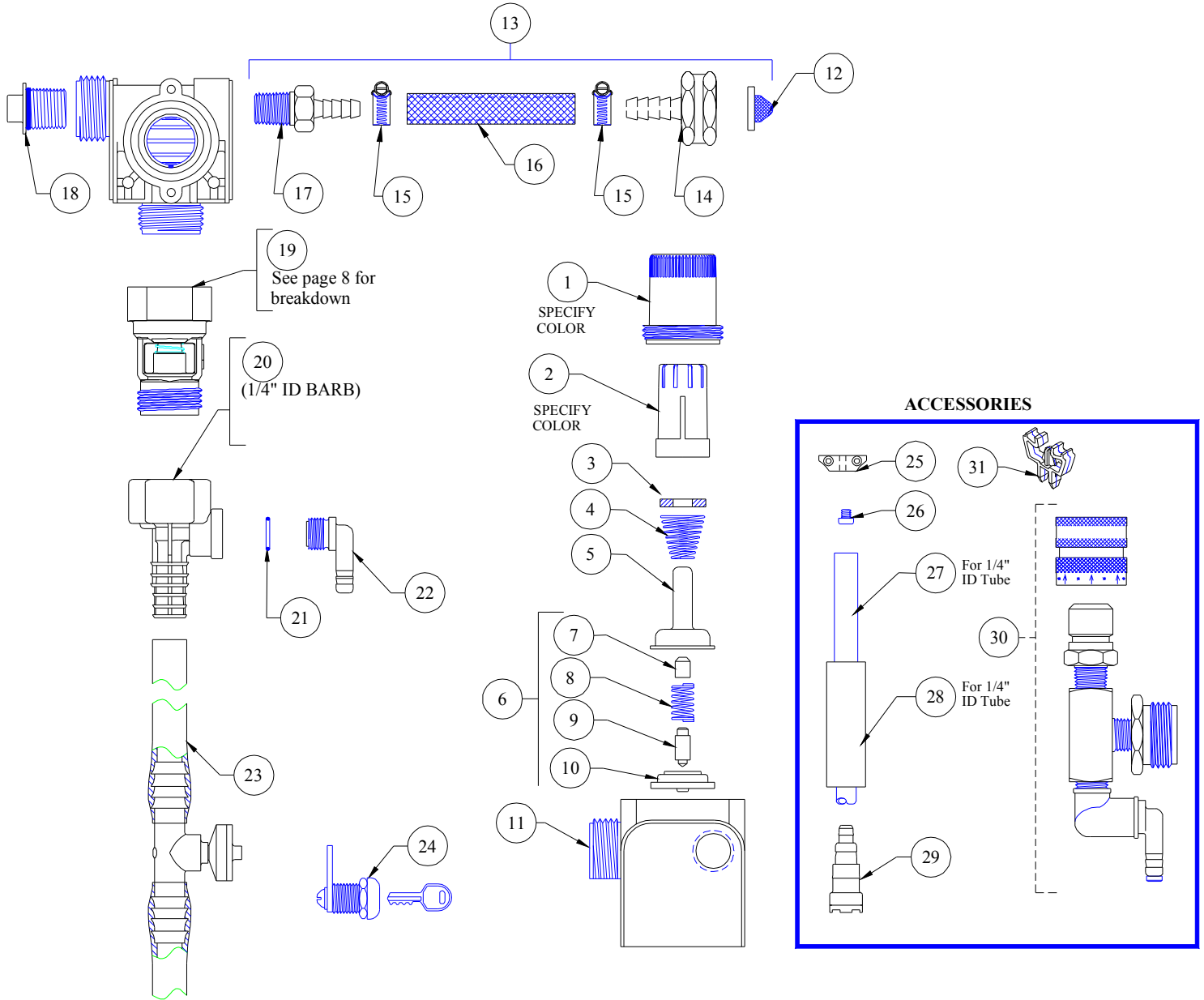

| QTY. | PART NO. | DESCRIPTION |
|------|------------|--|
| 1 | 66-139 | Magnet Housing (Specify Color) |
| 2 | 66-140 | Push Button (Specify Color) |
| 3 | 63-35 | Magnet |
| 4 | 63-36 | Spring |
| 5 | 41-7-25 | Enclosing Tube |
| 6 | 63-87 | Valve Repair Kit |
| 7 | 63-37 | Spacer |
| 8 | 41-1-8 | Kick-off spring |
| 9 | 63-38 | Plunger |
| 10 | 41-15-5 | Diaphragm |
| 11 | 63-39 | Valve Body |
| 12 | 100-38 | Strainer Washer |
| 13 | 66-156 | Water Inlet Assy. |
| 14 | 66-142 | Female GHT Swivel Coupling |
| 15 | 76-2-3 | Worm Hose Clamp (Req'd 2) |
| 16 | 66-98-4 | 3/8" Braided Tubing 2.75" Lg. |
| 17 | 66-119 | Hose Barb |
| 18 | 66-153 | Pipe Plug & O-Ring Assy. |
| 19 | 16-30 | Action Gap Assembly |
| 20 | 61-22GAP-2 | 4 GPM (1/4" ID Barb) Proportioner (Gray) |

| QTY. | PART NO. | DESCRIPTION |
|------|----------|---|
| 21 | 63-78 | O-Ring |
| 22 | 63-79 | Inlet Barb (1/4" ID Barb) |
| 23 | 61-21 | 1/2" ID X 6' Lg. Vinyl Outlet Tube (4 GPM Only) |
| 24 | 66-21 | Cabinet Lock |

ACCESSORIES

| QTY. | PART NO. | DESCRIPTION |
|------|----------|--------------------------------------|
| 25 | 66-165 | Hinge |
| 26 | 100-15K | Metering Tip Kit-14 Sizes |
| 27 | 100-12 | 1/4" ID X 8' Lg. Vinyl Supply Tubing |
| 28 | 61-107-2 | Ceramic Weight |
| 29 | 100-11P | Foot Valve |
| 30 | 68-6-QD2 | Pressure Indicating Tee |
| 31 | 67-4-1 | Box Clip |