

DEMA 661AG-4 BLEND SAFE INSTALLATION INSTRUCTIONS

REFER TO
PAGE 7
FOR PARTS
BREAKDOWN

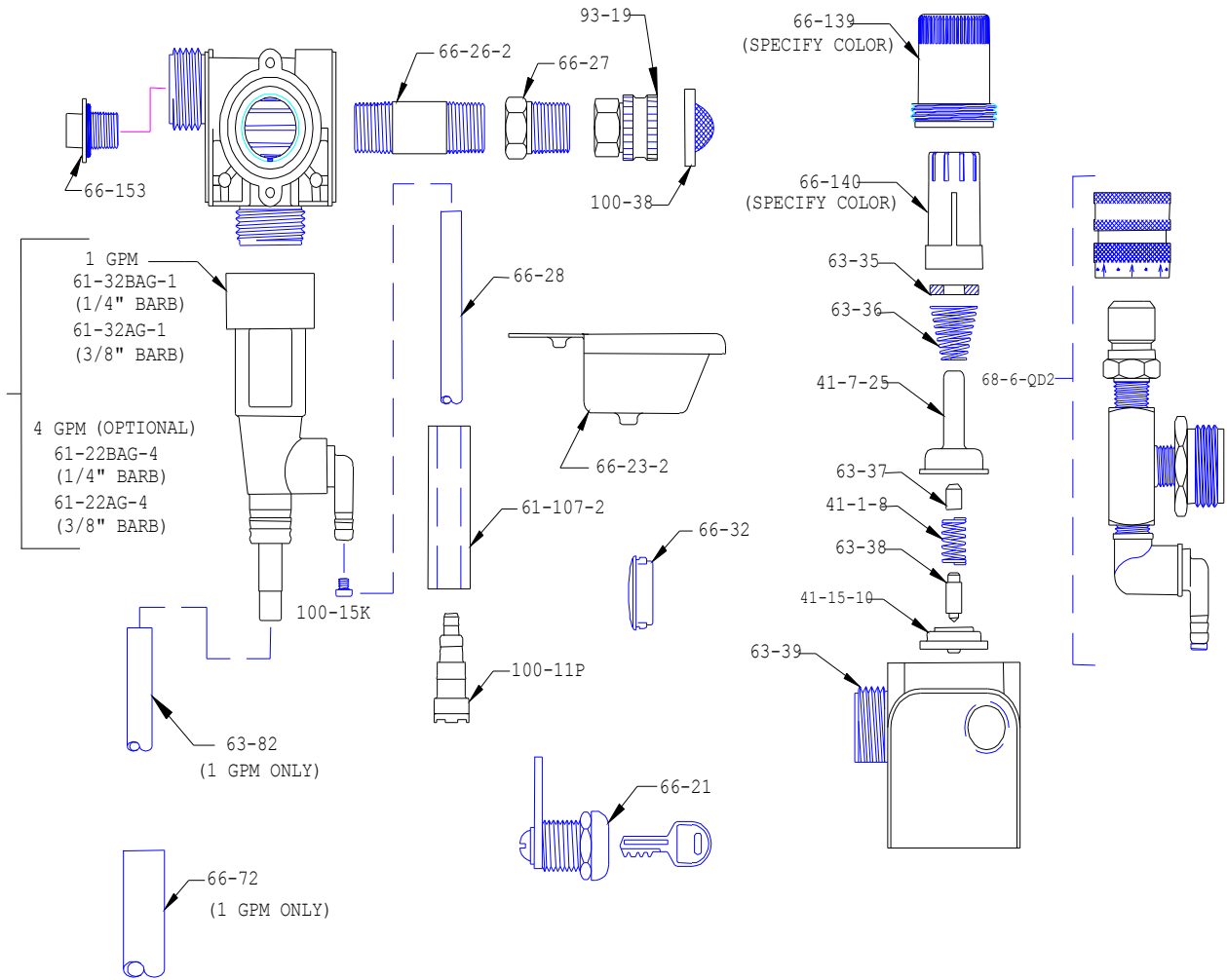

PART NO.	DESCRIPTION
41-1-8	KICK-OFF SPRING
41-7-25	ENCLOSING TUBE
41-15-10	DIAPHRAGM
61-22BAG-4	4 GPM PROPORTIONER-1/4" BARB
61-32BAG-1	1 GPM PROPORTIONER-1/4" BARB
61-107-2	CERAMIC WEIGHT
63-35	MAGNET
63-36	SPRING
63-37	SPACER
63-38	PLUNGER
63-39	VALVE BODY
63-82	VINYL TUBE (3/16" ID X 7" LG) 1 GPM ONLY
66-21	CABINET LOCK
66-23-2	DRIP TRAY
66-26-2	PIPE NIPPLE (3/8" NPT X 2" LG)
66-27	BUSHING

PART NO.	DESCRIPTION
66-28	VINYL TUBING
66-32	PLUG
66-72	9/16 I.D TUBE X 6" LG. 1 GPM ONLY
66-139	MAGNET HOUSING (SPECIFY COLOR)
66-140	PUSH BUTTON (SPECIFY COLOR)
66-153	PIPE PLUG
93-19	SWIVEL ADAPTOR
100-11P	FOOT VALVE
100-38	STRAINER WASHER

ACCESSORIES

61-22AG-4	4 GPM PROPORTIONER-3/8" BARB
61-32AG-1	1 GPM PROPORTIONER-3/8" BARB
68-6-QD2	PRESSURE INDICATING TEE
100-15K	METERING TIP KIT (13 SIZES)