

DEMA 635AG-1 & 635AG-4 MULTI-BLEND CENTER

DEMA 635AG BLEND CENTER

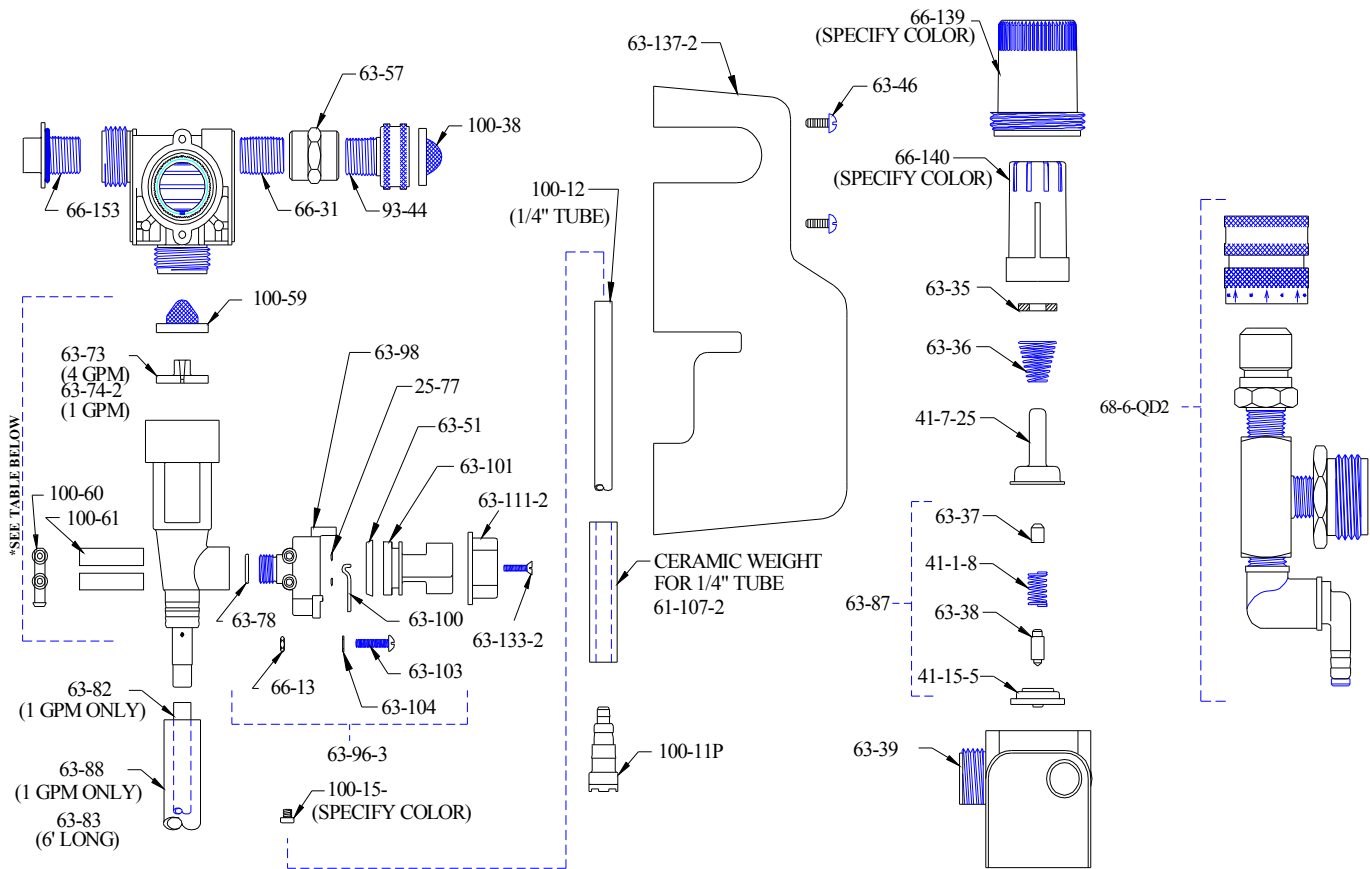

PART NO.	DESCRIPTION
25-77	O-RING
41-1-8	KICK-OFF SPRING
41-7-25	ENCLOSING TUBE
41-15-5	DIAPHRAGM
61-107-2	CERAMIC WEIGHT (1/4" TUBE)
61-126AG-4	*4 GPM PROPORTIONER ASSY (WHITE)
61-126AG-1	*1 GPM PROPORTIONER ASSY (GREEN)
63-35	MAGNET
63-36	SPRING
63-37	SPACER
63-38	PLUNGER
63-39	VALVE BODY
63-46	SCREW
63-51	"U" CUP
63-57	COUPLING
63-73	NOZZLE (4 GPM)
63-74-2	NOZZLE (1 GPM)
63-78	O-RING
63-82	VINYL TUBE (3/16" ID X 7" LG) 1 GPM ONLY
63-83	VINYL TUBE (9/16 ID X 6' LG)
63-87	VALVE REPAIR KIT
63-88	VINYL TUBE (9/16" ID X 4" LG) 1 GPM ONLY
63-96-3	SELECTOR VALVE ASSEMBLY
63-98	SELECTOR VALVE BODY
63-100	RETAINER

PART NO.	DESCRIPTION
63-101	KNOB
63-103	SCREW
63-104	WASHER
63-111-2	SELECTOR KNOB
63-133-2	#6 FL. HD. HI-LO SCREW
63-137-2	COVER
66-13	NUT
66-31	PIPE NIPPLE
66-139	MAGNET HOUSING (SPECIFY COLOR)
66-140	PUSH BUTTON (SPECIFY COLOR)
66-153	PIPE PLUG
93-44	PIPE TO GARDEN HOSE ADAPTOR
100-11P	FOOT VALVE
100-12	VINYL TUBE (1/4 ID X 8' LG.)
100-15-	METERING TIP (SPECIFY COLOR)
100-38	STRAINER WASHER
100-59	STRAINER WASHER
100-60	BARB CONNECTOR TEE
100-61	VINYL TUBING (1/4 I.D. X 4" LG)

ACCESSORIES

61-25-2	FRESH WATER OUTLET KIT
68-6-QD2	PRESSURE INDICATING TEE
100-15K	METERING TIP KIT (14 SIZES)