

DEMA 633AG-1 & 633AG-4 BLEND CENTER

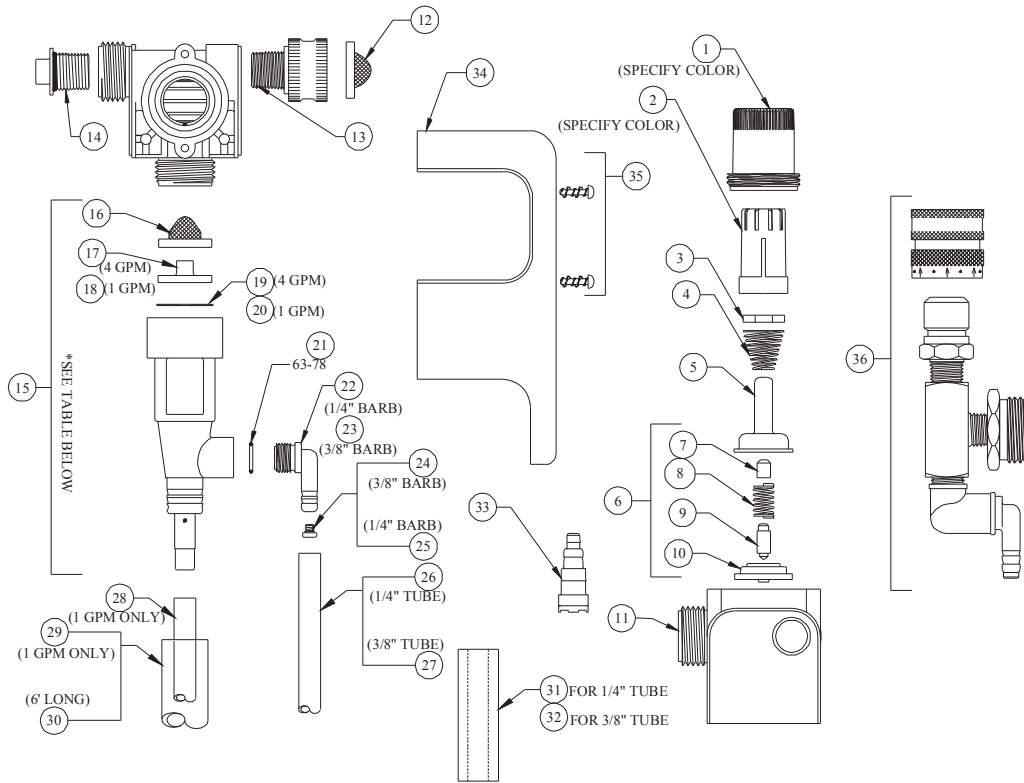

NO.	PART NO.	DESCRIPTION
1	66-139	Magnet Housing (Specify Color)
2	66-140	Push Button (Specify Color)
3	63-35	Magnet
4	63-36	Spring
5	41-7-25	Enclosing Tube
6	63-87	Valve Repair Kit
7	63-37	Spacer
8	41-1-8	Kick-Off Spring
9	63-38	Plunger
10	41-15-10	Diaphragm
11	63-39	Valve Body
12	100-38	Strainer Washer
13	93-44	Pipe To Garden Hose Adapter
14	66-153	Pipe Plug & O-Ring Assy.
15	61-22-3AG	4 GPM(3/8" Barb) Proportioner
	61-22-3BAG	4 GPM(1/4" Barb) Proportioner
	61-32AG	1 GPM(3/8" Barb) Proportioner
	61-32BAG	1 GPM(1/4" Barb) Proportioner
16	100-59	Strainer Washer
17	63-73	Nozzle (4 GPM)
18	63-74-2	Nozzle (1 GPM)
19	63-76	Screen (4 GPM)
20	63-77	Screen (1 GPM)
21	63-78	O-Ring

NO.	PART NO.	DESCRIPTION
22	63-79	Inlet Barb (1/4" Barb)
23	63-80	Inlet Barb (3/8" Barb)
24	61-9	Metering Tip
25	100-15	Metering Tip
26	100-12	Vinyl Tube (7/32" ID X 8 ft. Lg.)
27	100-12L	Vinyl Tube (3/8" ID X 8 ft. Lg.)
28	63-82	Vinyl Tube (3/16" ID X 7" Lg.)
29	63-88	Vinyl Tube (9/16" ID X 4" Lg.) (1 GPM Only)
30	63-83	Vinyl Tube (3/16" ID X 6 Ft. Lg.)
31	61-107-2	Ceramic Weight (For 3/8" OD Tubing)
32	61-107	Ceramic Weight (For 1/2" OD Tubing)
33	100-11P	Foot Valve
34	63-45	Cover
35	63-46	Screw

ACCESSORIES		
NO.	PART NO.	DESCRIPTION
36	68-6-QD2	Pressure Indicating Tee
37	61-25-2	Fresh Water Outlet Kit
38	100-15K	Metering Tip Kit (14 Sizes)
39	61-9K	Metering Tip Kit (15 Sizes)