

# MODELS 295C-2, 295C-2 1/2, 295C-3 MODELS 295CS-2, 295CS-2 1/2, 295CS-3

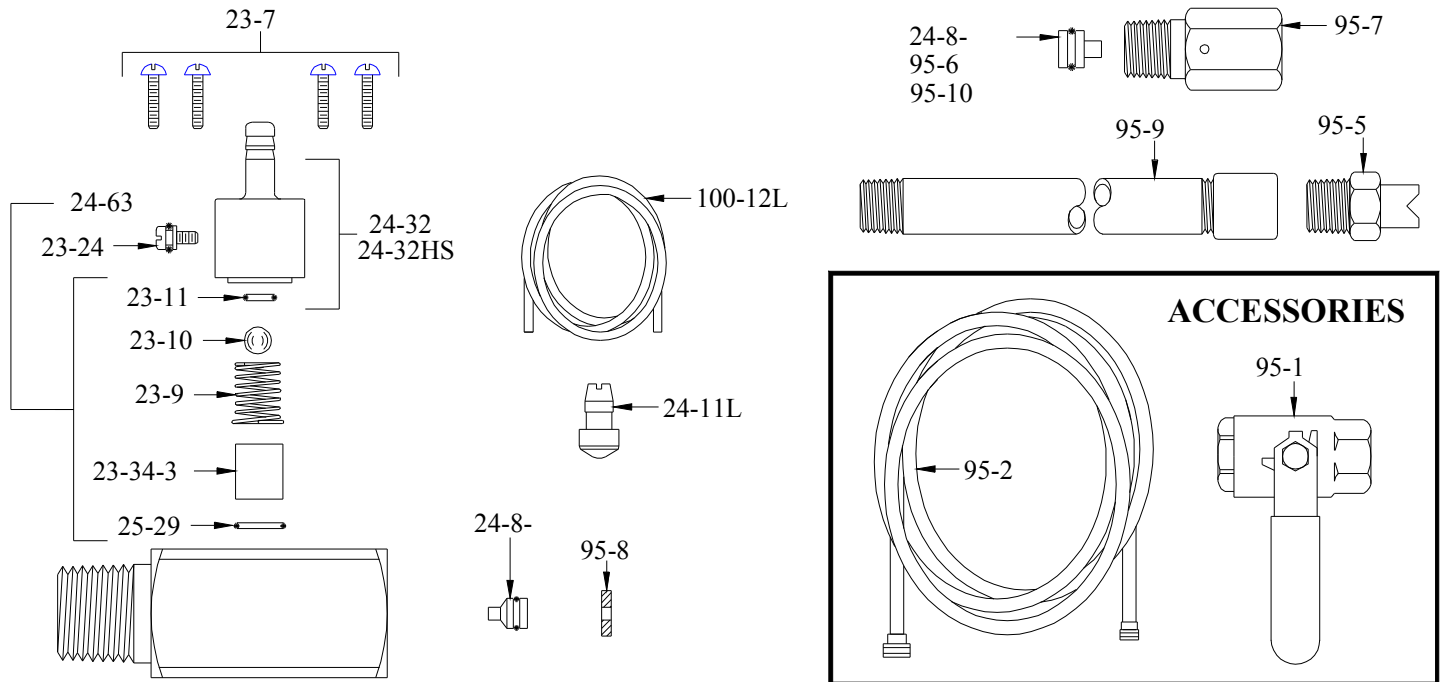

PART NO.	DESCRIPTION
23-7	SCREW #8-32, 1 LG. (4-REQD.)
23-9	CHECK VALVE SPRING
23-10	CHECK VALVE BALL
23-11	CHECK VALVE O-RING
23-24	METERING SCREW
23-32	METERING KNOB (INCLUDES METERING SCREW & O-RING)
23-32HS	METERING KNOB-STAINLESS STEEL (INCLUDES METERING SCREW & O-RING)
23-34-3	CHECK VALVE CORE
24-8-4	INJECTOR WATER NOZZLE (MODELS 295C-2 & 295CS-2)
24-8-5	INJECTOR WATER NOZZLE (MODELS 295C-2 1/2 & 295CS-2 1/2)
24-8-6	INJECTOR WATER NOZZLE (MODELS 295C-3 & 295CS-3)
24-8-8	AERATOR NOZZLE (MODELS 295C-3 & 295CS-3)
24-11L	FOOT STRAINER
24-63	REPAIR KIT
25-29	METERING KNOB O-RING
95-5	SPRAY NOZZLE
95-6	AERATOR NOZZLE(MODELS 295C-2 & 295CS-2)
95-7	AERATOR
95-8	BACK-UP WASHER
95-9	WAND & COUPLING
95-10	AERATOR NOZZLE (MODELS 295C-2 1/2 & 295CS-2 1/2)
100-12L	VINYL SUPPLY TUBING (1/2 O.D. X 8' LG.)

## ACCESSORIES

95-1	SHUTOFF VALVE
95-2	HIGH PRESSURE HOSE,(3/8 I.D. X 40' LG)