

# DEMA® MODEL 294DC FOAMER

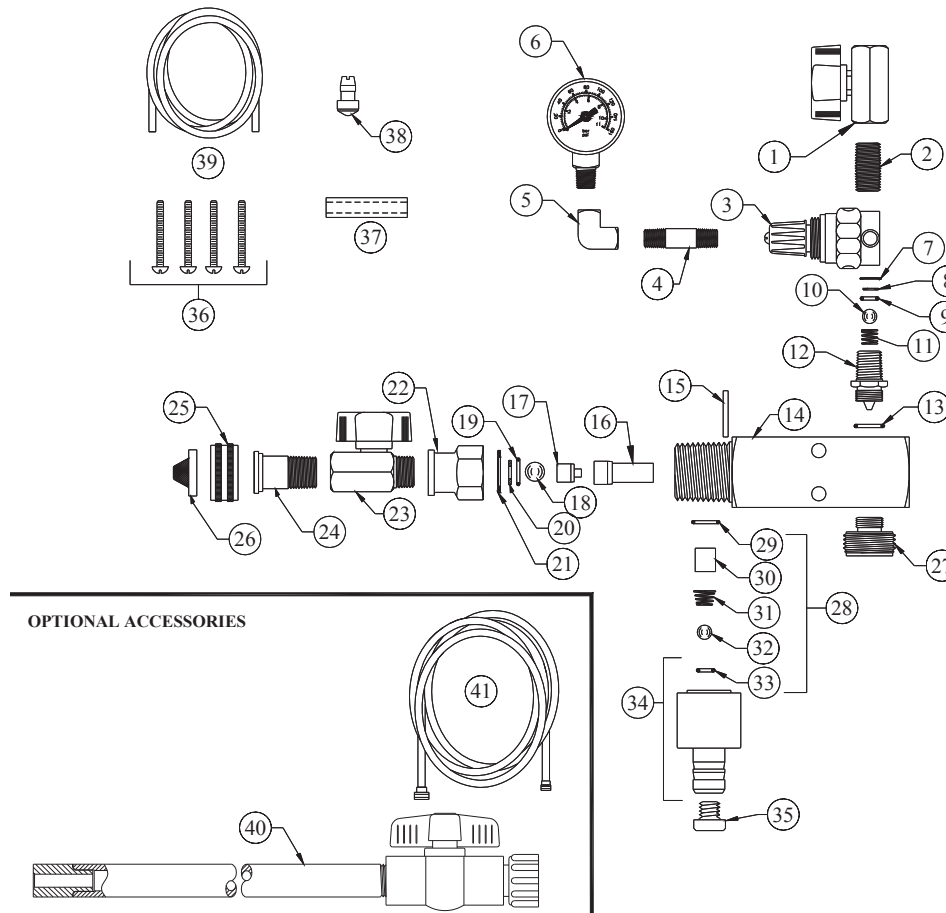

NO.	PART NO.	DESCRIPTION
1	16-11	Ball Valve (1/4" NPT)
2	25-137-9U	Close Nipple (1/4" NPT)
3	93-1	Pressure Regulator
4	93-103-1	Pipe Nipple (1/8" NPT)
5	93-102-1	Elbow (1/8" NPT)
6	93-15-1	Pressure Gauge
7	29-18-2	5/16" Internal Snap Ring
8	29-17-3	Stainless Steel Washer
9	90-35V	Air Check Valve O-Ring
10	26-49P	Ball 3/16" Teflon
11	93-6-2	Air Check Valve Spring
12	29-14	Air Nozzle Adapter
13	30-5V-14	O-Ring
14	29-6-1	Foamer Body
15	29-15	Pin
16	29-11	Diffuser
17	29-16	Water Nozzle
18	29-5P	Ball - 11/16" Dia.
19	29-7	O-Ring
20	29-17-2	Stainless Steel Washer
21	28-18-4	7/16" Snap Ring
22	93-105-1	Reducing Coupling (1/2" NPT x 3/8" NPT)

NO.	PART NO.	DESCRIPTION
23	65-2	Ball Valve (3/8" NPT)
24	93-104-1	Swivel Adapter Stem
25	65-10	Coupling
26	100-38	Strainer Washer
27	29-8	Outlet
28	29-12	Check Valve Repair Kit
29	25-29V	Metering Knob O-Ring
30	23-34-3	Check Valve Core
31	23-9-2	Check Valve Spring
32	23-10	Teflon Ball - 9/32" Dia.
33	23-11V	Check Valve O-Ring
34	23-32T	Metering Knob
35	61-9 61-9K	Metering Tip (Specify Color or Metering Tip Kit)
36	29-10	Hi-Lo Screw (4 Reqd.)
37	61-107	Ceramic Weight
38	24-11L	Foot Strainer
39	100-12L	1/2"OD Vinyl Tubing x 8'Lg.

OPTIONAL ACCESSORIES		
NO.	PART NO.	DESCRIPTION
40	93-18	Spray Wand
41	93-14	3/4"ID x 25'Lg. Outlet Hose