

SPRAY FOAM-MODEL 294 CDM & 294CTDM

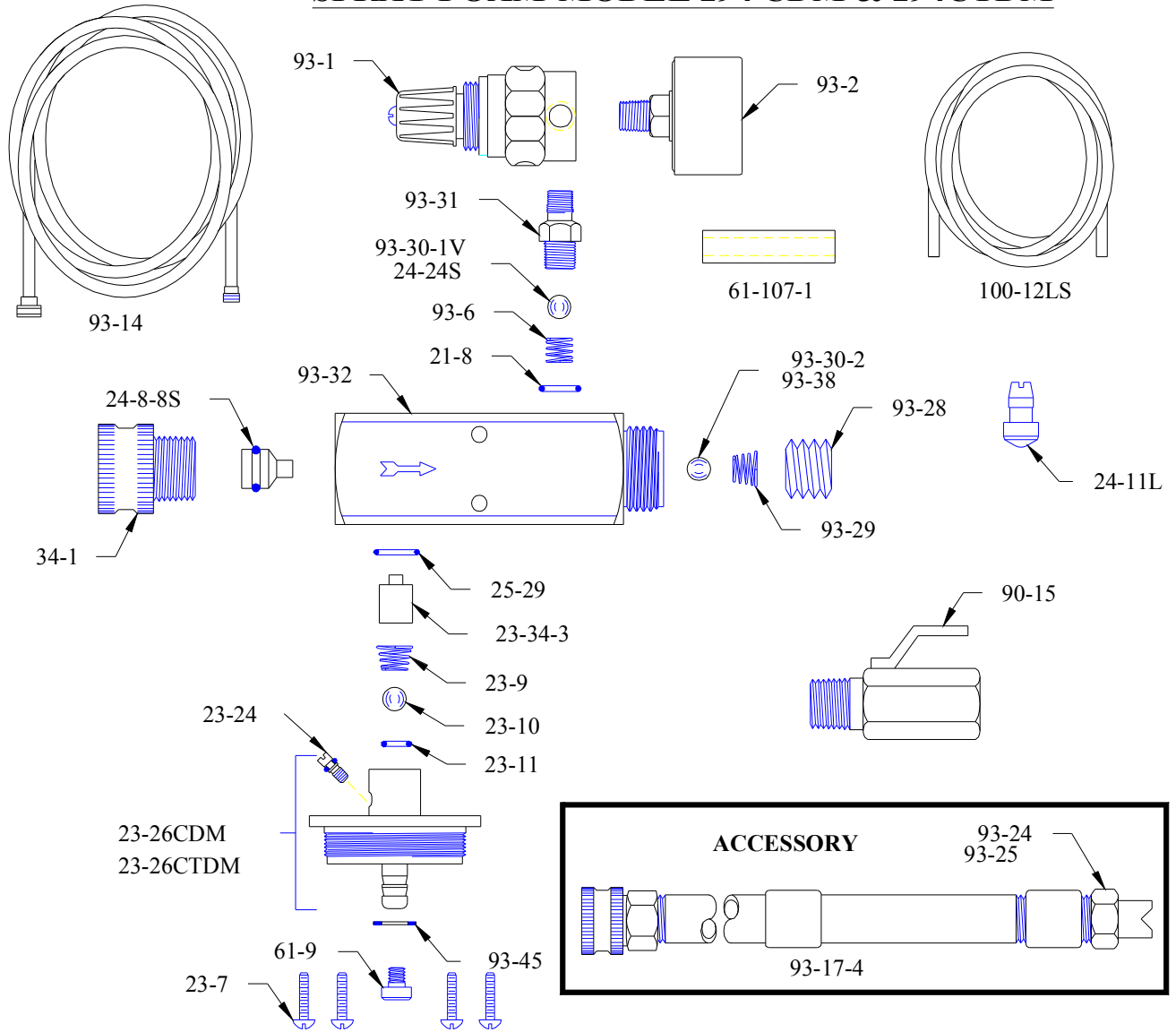

PART NO.	DESCRIPTION	PART NO.	DESCRIPTION
21-8	AIR CHECK VALVE O-RING	93-1	PRESSURE REGULATOR
23-7	MACHINE SCREW (4 REQD)	93-2	PRESSURE GAGE
23-9	CHECK VALVE SPRING	93-6	AIR CHECK VALVE SPRING
23-10	CHECK VALVE BALL (9/32 DIA STNLS. STL.)	93-14	3/4" ID X 25' LG. OUTLET HOSE
23-11	CHECK VALVE O-RING	93-28	RETAINER SCREW
23-24	METERING SCREW W/ O-RING (294CDM ONLY)	93-29	SPRING
23-26CDM	METERING KNOB & BUNG ASSEMBLY (294 CDM ONLY)	93-30-1V	BALL 1/4 DIA
23-26CTDM	METERING KNOB & BUNG ASSEMBLY (294 CDM ONLY)	93-30-2	BALL 5/16" DIA
23-34-3	CHECK VALVE CORE	93-31	ADAPTER
24-8-8S	WATER NOZZLE W/ O-RING	93-32	FOAMER BODY
24-11L	FOOT STRAINER	93-38	STAINLESS STEEL BALL 5/16" (294CDMT ONLY)
24-24S	STAINLESS STEEL BALL 1/4" (294CDMT ONLY)	93-45	SNAP RING
24-63	CHECK VALVE REPAIR KIT	100-12LS	1/2" OD VINYL TUBING X 8'3 1/2' LG.
25-29	METERING KNOB O-RING		
30-2V	BALL 5/16" RUBBER		
34-1	INLET HOSE ADAPTER		
61-9	METERING TIP-SPECIFY COLOR (294CDMT ONLY)		
61-107-1	CERAMIC WEIGHT		
90-15	OUTLET SHUTOFF VALVE		
			ACCESSORIES
		93-17-4	4' LG. SPRAY WAND W/ SOLID STREAM NOZZLE
		93-24	NOZZLE W/ SOLID STREAM (SUPPLIED)
		93-25	NOZZLE W/ 40° ANGLE