

SPRAY FOAM-MODEL 294C

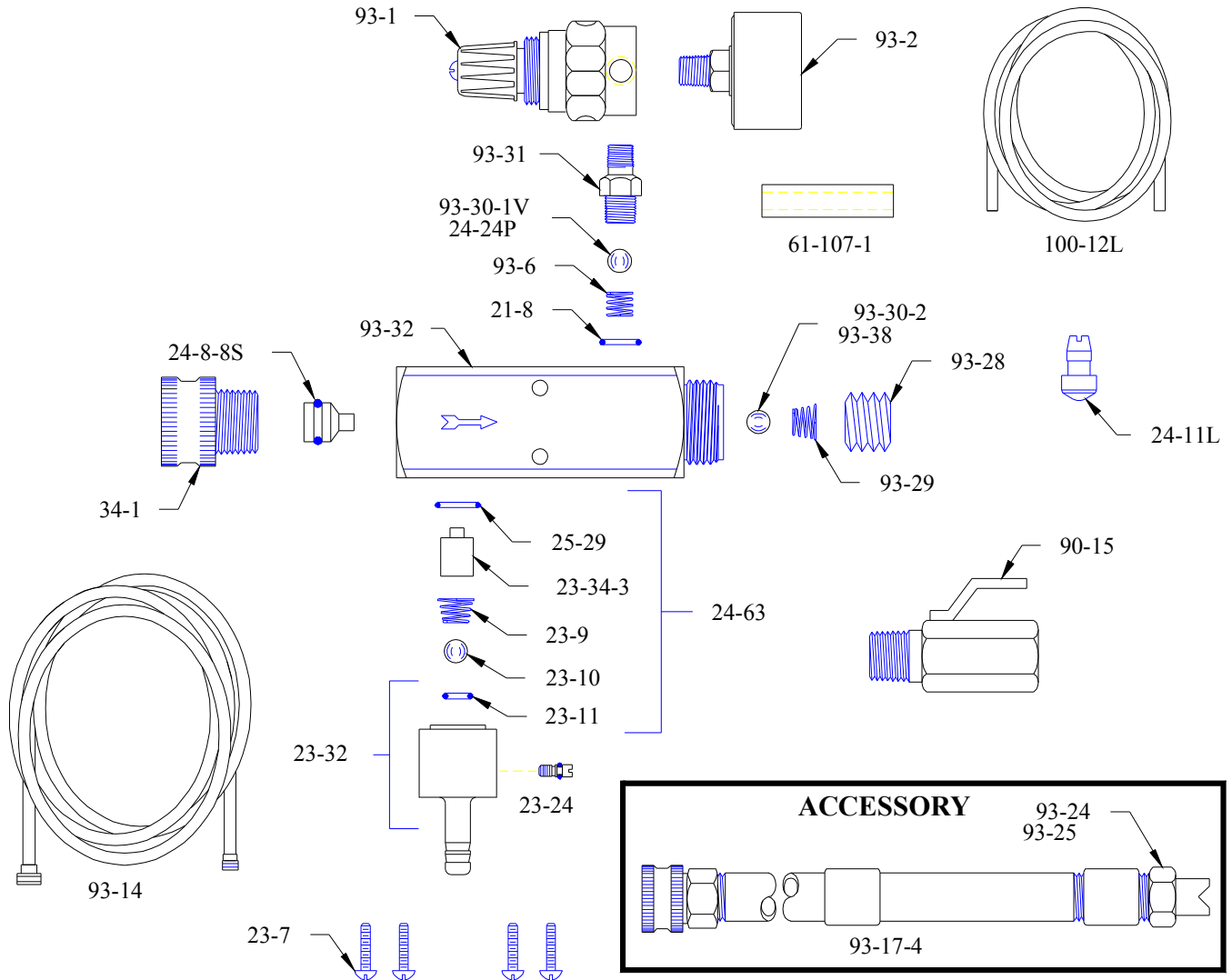

PART NO.	DESCRIPTION
21-8	AIR CHECK VALVE O-RING
23-7	MACHINE SCREW (4 REQD)
23-9	CHECK VALVE SPRING
23-10	CHECK VALVE BALL (9/32 DIA STNLS. STL.)
23-11	CHECK VALVE O-RING
23-24	METERING SCREW W/ O-RING
23-32	METERING KNOB W/ METERING SCREW & O-RING
23-34-3	CHECK VALVE CORE
24-8-8S	WATER NOZZLE W/ O-RING
24-11L	FOOT STRAINER
24-24P	BALL 1/4" TEFLON (294C-SJ3)
24-63	CHECK VALVE REPAIR KIT
25-29	METERING KNOB O-RING
34-1	INLET HOSE ADAPTER
61-107-1	CERAMIC WEIGHT
90-15	OUTLET SHUTOFF VALVE
93-1	PRESSURE REGULATOR
93-2	PRESSURE GAGE

PART NO.	DESCRIPTION
93-6	AIR CHECK VALVE SPRING
93-14	3/4" ID X 25' LG. OUTLET HOSE
93-28	RETAINER SCREW
93-29	SPRING
93-30-1V	BALL 1/4 DIA
93-30-2	BALL 5/16" DIA
93-31	ADAPTER
93-32	FOAMER BODY
93-38	BALL 5/16" STNLS. STL. (294C-SJ3 ONLY)
100-12L	1/2" OD VINYL TUBING X 8' LG.

ACCESSORIES	
93-17-4	4' LG. SPRAY WAND W/ SOLID STREAM NOZZLE
93-24	NOZZLE W/ SOLID STREAM (SUPPLIED)
93-25	NOZZLE W/ 40° ANGLE