

# DEMA 257B AND 257BV DRAIN MASTER

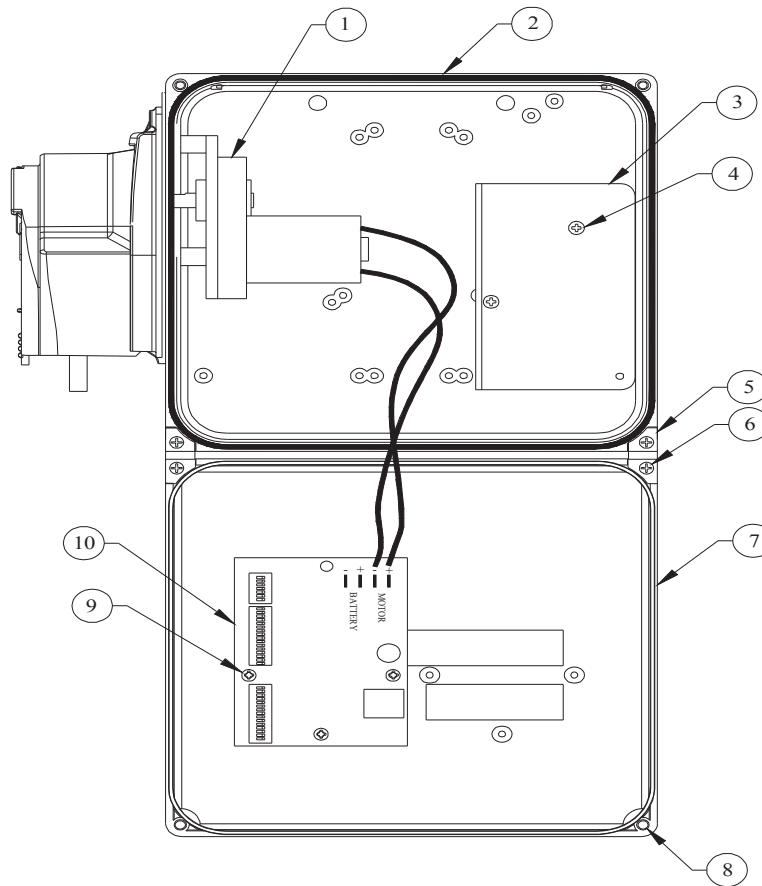

## REPLACEMENT PARTS

NO.	DEMA PART NO.	DESCRIPTION	QTY.
1	25-66C	Gear Motor Assembly	1
2	81-61-1	Electrical Enclosure Assembly	1
3	25-123-1	Battery Retainer Bracket	1
4	44-116-1	Battery Retainer Screws	3
5	81-23	Electrical Enclosure Hinge	2
6	81-19-1	Hinge Screw	2
7	85-31	Electrical Enclosure Cover	1
8	81-29-2	Captive Screw for Electrical Enclosure Cover	2
9	81-20-2	Control Board Screw	3
10	25-122-1	Drain Master Electronic Control Board	1

## INSTALLATION KIT PARTS (NOT SHOWN ON DRAWING)

DEMA PART NO.	DESCRIPTION	QTY.
81-16-1	Tie Wrap 8" lg.	4
81-182-1	1/4" x 1/4" JG Union	2
25.68.20	20 Ft of 1/4" LDPE Tubing (white)	1
80.66	10" Pick Up Tube Assembly	1
81.1	Wall Bracket Kit	1
25.125.1	Battery Cable Assembly	1
25.69	AC to DC Adapter (U.S., 120V 60Hz – 12VDC)	1