

# DEMA SPRAY CLEAN

## MODELS: 244CDM & 244CDMT

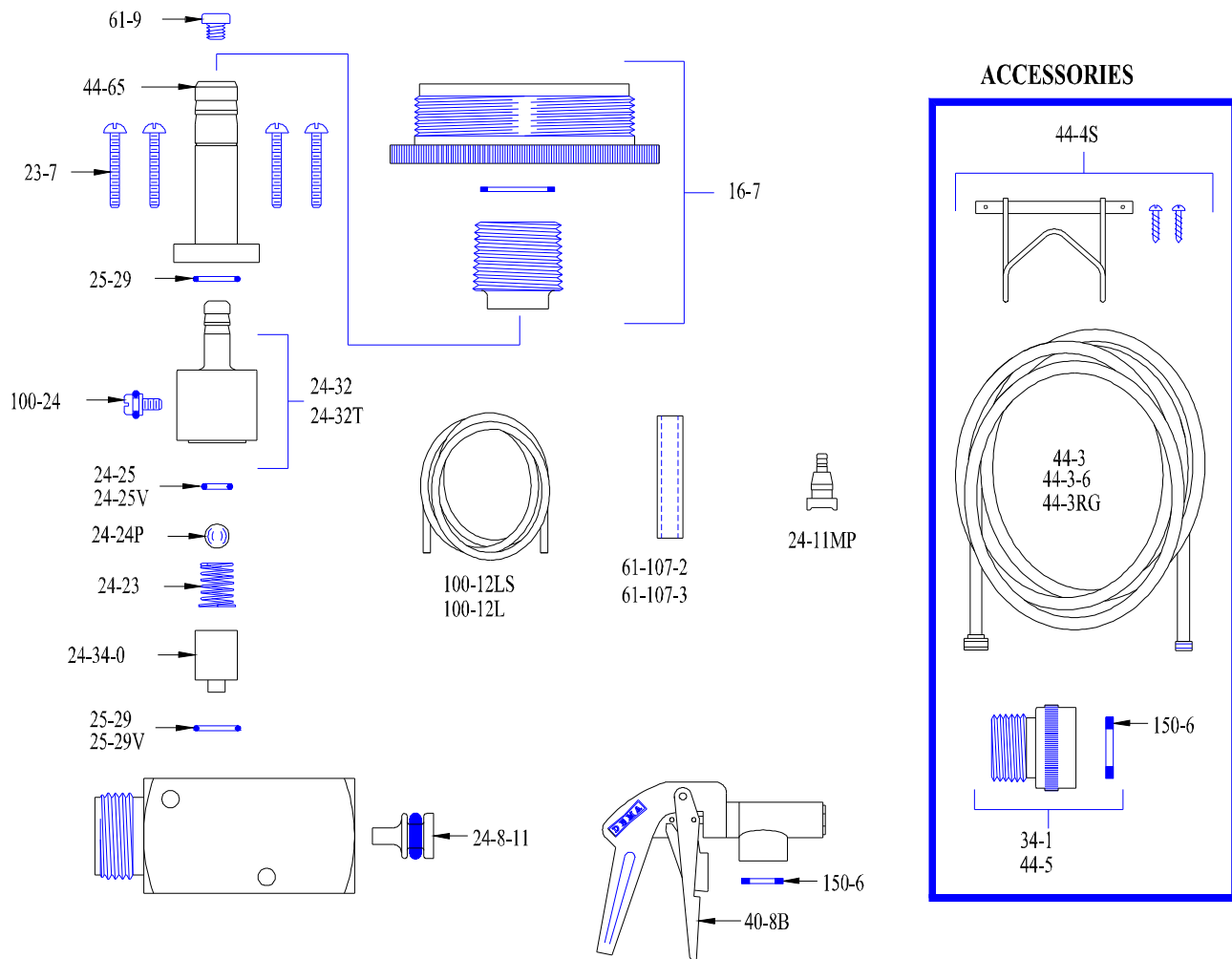

PART NO.	DESCRIPTION
16-7	BUNG ASSEMBLY
23-7	SCREW - 4 REQ'D.
24-8-11	WATER NOZZLE
24-11MP	FOOT STRAINER
24-23	CHECK VALVE SPRING
24-24P	CHECK VALVE BALL
24-32	METERING KNOB ASSEMBLY (MODEL 244CDM)
24-32T	METERING KNOB ASSEMBLY (MODEL 244CDMT)
24-34-0	CHECK VALVE CORE
25-29	O-RING (2 REQ'D)
40-8B	SPRAY GUN
44-65	DRUM NIPPLE

PART NO.	DESCRIPTION
61-107-2	CERAMIC WEIGHT
61-9	METERING TIP-SPECIFY SIZE (MODEL 244CDMT)
100-12LS	3 1/2 FEET OF 3/8" I.D. VINYL TUBING
100-24	METERING SCREW W/ O-RING (MODEL 244CDM)
150-6	RUBBER WASHER

MODEL 244CDMT-T	
24-25V	O-RING
25-29V	O-RING (2 REQ'D)
44-5	INLET ADAPTER
61-107-3	PVC WEIGHT
100-12L	8 FEET OF 3/8" I.D. VINYL TUBING

### ACCESSORIES

34-1	PIPE TO HOSE INLET ADAPTER W/ WASHER
44-3	25 FEET OF 1/2" HIGH PRESSURE HOSE
44-3-6	6 FEET OF 1/2" HIGH PRESSURE HOSE
44-4S	HOSE BRACKET W/ MOUNTING SCREWS
44-3RG	25' X 1/2" RED HOSE W/ POLY GUARDS