

# DEMA SPRAY CLEAN

## MODELS: 241CDF & 241CDFT

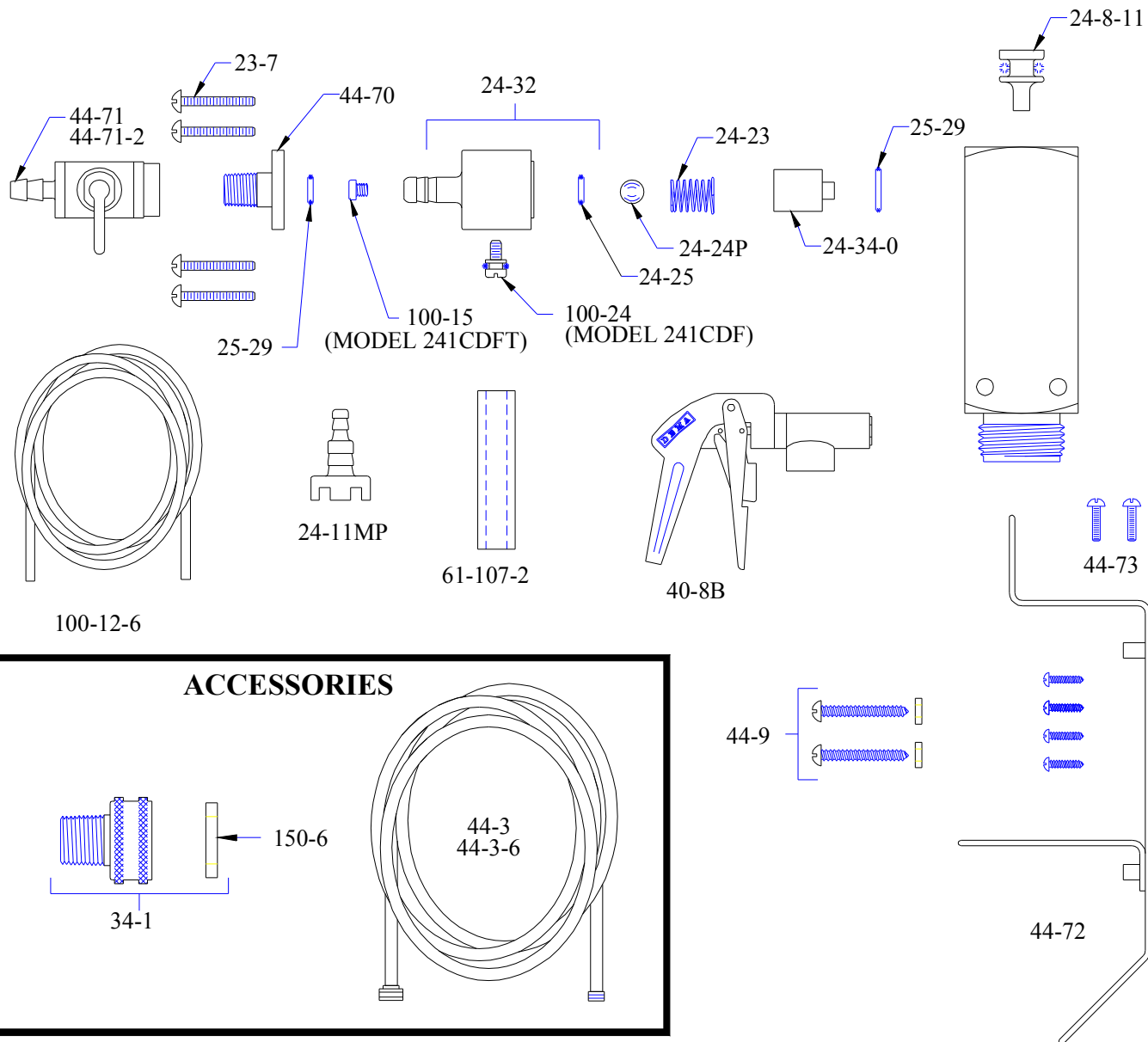

PART NO.	DESCRIPTION
23-7	SCREW 8-32 X 1 LG. (4-REQD)
24-8-11	WATER NOZZLE
24-11MP	FOOT STRAINER
24-23	CHECK VALVE SPRING
24-24P	CHECK VALVE BALL
24-25	CHECK VALVE O-RING
24-32	METERING KNOB ASSEMBLY
24-34-0	CHECK VALVE CORE
25-29	METERING KNOB O-RING
40-8B	SPRAY GUN
44-9	SET OF TWO MOUNTING SCREWS W/ SPACERS
44-70	PIPE NIPPLE FITTING
44-71	BALL VALVE (POLYPROPYLENE)

PART NO.	DESCRIPTION
44-71-2	BALL VALVE (OPTIONAL BRASS)
44-72	BOTTLE HOLDER W/ MOUNTING SCREWS (4 REQ'D)
44-73	SCREW 1/4-20 X 1/2 LG (2-REQD)
61-107-2	CERAMIC WEIGHT
100-12-6	18" OF 7/32" I.D. VINYL TUBING
100-15	METERING TIP (SPECIFY COLOR)
100-24	METERING SCREW W/ O-RING

ACCESSORIES	
34-1	HOSE INLET ADAPTER W/ WASHER
44-3	25 FEET OF 1/2" HIGH PRESSURE HOSE
44-3-6	6 FEET OF 1/2" HIGH PRESSURE HOSE
150-6	GARDEN HOSE RUBBER WASHER