

WALL MOUNTED SPRAY CLEAN MODELS: 241C, 241CP, 241CT

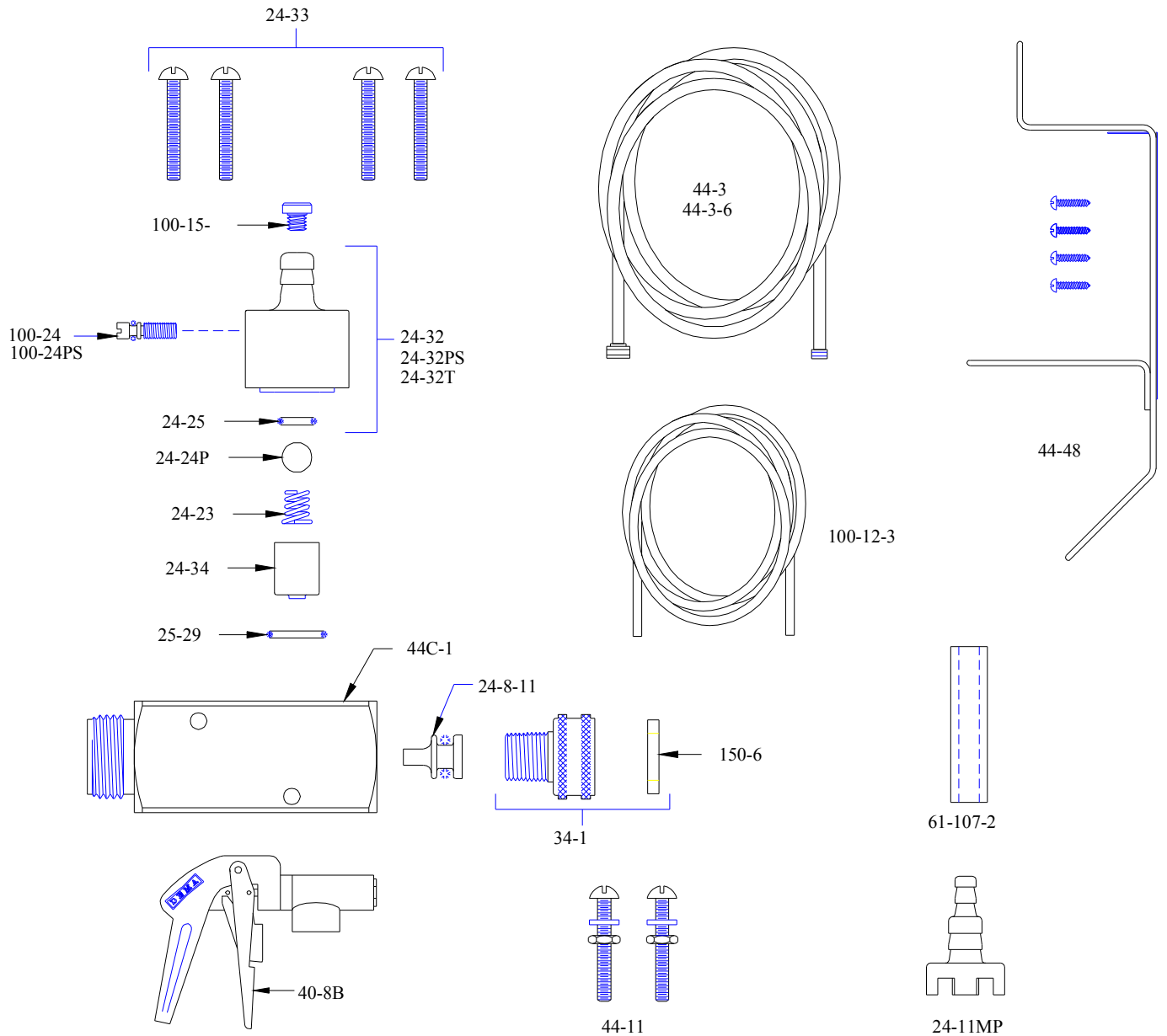

| PART NO. | DESCRIPTION |
|----------|--------------------------------------|
| 24-8-11 | WATER NOZZLE |
| 24-11MP | FOOT STRAINER |
| 24-23 | CHECK VALVE SPRING |
| 24-24P | CHECK VALVE BALL |
| 24-25 | CHECK VALVE O-RING |
| 24-32 | METERING KNOB ASSY. (MODEL 241C) |
| 24-32PS | METERING KNOB ASSY. (MODEL 241CP) |
| 24-32T | METERING KNOB ASSY. (MODEL 241CT) |
| 24-33 | SCREW #8-32 X 7/8 LG. (4-REQD.) |
| 24-34- | CHECK VALVE CORE (SPECIFY MODEL NO.) |
| 25-29 | METERING KNOB O-RING |
| 34-1 | HOSE SWIVEL ADAPTER W/ WASHER |

| PART NO. | DESCRIPTION |
|----------|--|
| 40-8B | SPRAY GUN |
| 44-3 | 25' OF 1/2" I.D. HIGH PRESSURE HOSE |
| 44-11 | INJECTOR MOUNTING SCREWS |
| 44-48 | BOTTLE HOLDER & HOSE RACK WITH MOUNTING SCREWS |
| 44C-1 | BODY ASSEMBLY |
| 61-107-2 | CERAMIC WEIGHT (FOR 1/4" I.D. TUBE) |
| 100-12-3 | 16" OF 3/8" O.D. VINYL TUBING |
| 100-24 | METERING SCREW W/ O-RING (MODEL 241C) |
| 100-24PS | METERING SCREW W/ O-RING (MODEL 241CP) |

ACCESSORIES

| | |
|--------|------------------------------------|
| 44-3-6 | 6' OF 1/2" I.D. HIGH PRESSURE HOSE |
|--------|------------------------------------|