

MODEL 241BC & 241BCP WALL MOUNTED SPRAY CLEAN

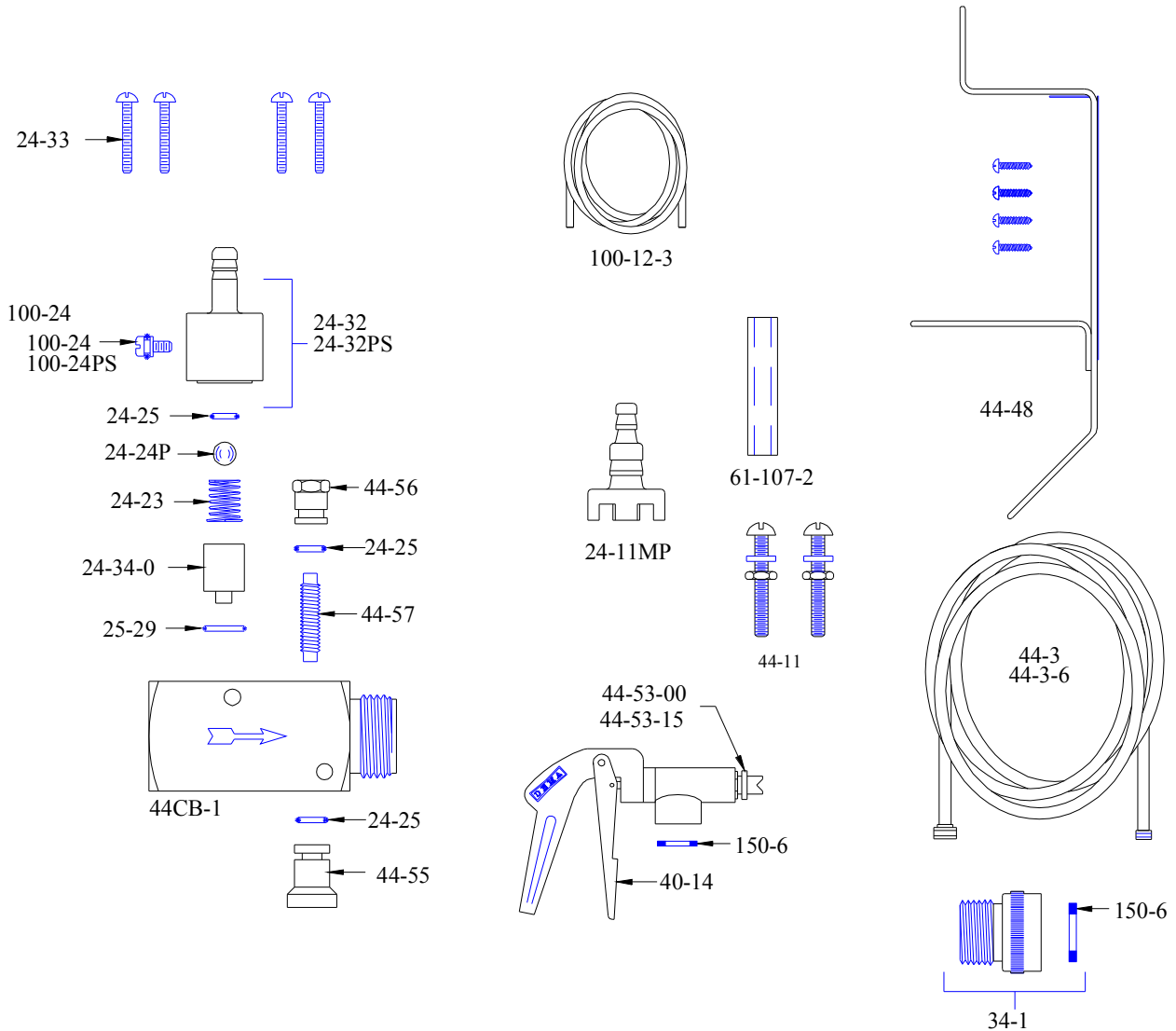

PART NO.	DESCRIPTION
24-11MP	FOOT STRAINER
24-23	CHECK VALVE SPRING
24-24P	CHECK VALVE BALL
24-25	CHECK VALVE O-RING
24-32	METERING KNOB ASSEMBLY (MODEL 241BC)
24-32PS	METERING KNOB ASSEMBLY (MODEL 241BCP)
24-33	SCREW - 4 REQ'D
24-34-0	CHECK VALVE CORE
25-29	METERING KNOB O-RING
34-1	PIPE TO HOSE INLET ADAPTER W/ WASHER
40-14	SPRAY GUN
44-3	25 FEET OF 1/2" HIGH PRESSURE HOSE
44-3-6	6 FEET OF 1/2" HIGH PRESSURE HOSE
44-11	INJECTOR MOUNTING SCREWS W/ NUTS AND WASHERS
44-48	BOTTLE HOLDER AND HOSE RACK WITH MOUNTING SCREWS

PART NO.	DESCRIPTION
44-53-00	SPRAY NOZZLE (0°) 4 GPM
44-53-15	SPRAY NOZZLE (15°) 4 GPM
44-55	BY-PASS VALVE (BOTTOM)
44-56	BY-PASS VALVE (TOP)
44-57	CONNECTING STUD
44CB-1	BODY ASSEMBLY (INCLUDES METERING KNOB AND CHECK VALVE PARTS)
61-107-2	CERAMIC WEIGHT (FOR 1/4" TUBE)
100-12-3	16" OF 3/8" O.D. PLASTIC TUBING (MODEL 241)
100-24	METERING SCREW W/ O-RING (MODEL 241BC)
100-24PS	METERING SCREW W/ O-RING (MODEL 241BCP)
150-6	RUBBER WASHER