

LIQUID DETERGENT FEEDER DEMA MODEL 219C FOR DISHWASHERS

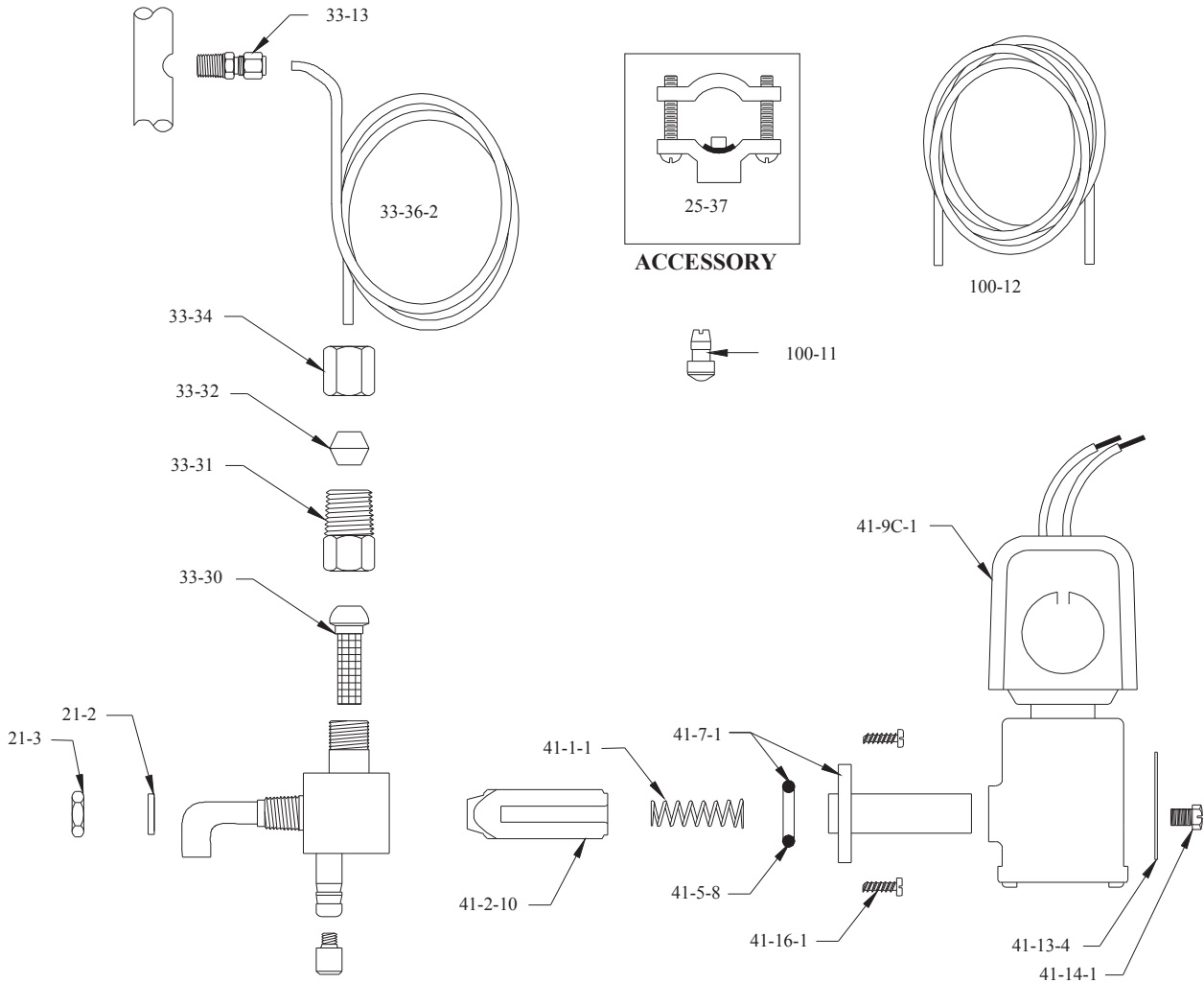

PART NO.	DESCRIPTION
21-2	MOUNTING GASKET
21-3	MOUNTING NUT
33-13	COMPRESSION COUPLING
33-30	STRAINER
33-31	ADAPTER
33-32	COMPRESSION SLEEVE
33-34	COMPRESSION NUT
33-36-2	1/4" O.D. X 448" LG. COPPER TUBING
41-1-1	PLUNGER SPRING
41-2-10	PLUNGER
41-5-8	TUBE ASSEMBLY O-RING
41-7-1	ENCLOSING TUBE & O-RING
41-9C-1	COIL ASSEMBLY (SPECIFY VOLTAGE)
41-13-4	NAMEPLATE (SPECIFY MODEL NO.)
41-14-1	TOP PLUG SCREW
41-16-1	ENCLOSING TUBE SCREW (2 REQ'D)
100-11	FOOT VALVE
100-12	VINYL TUBING (3/8" O.D. X 8' LG.)
100-15-9	METERING TIP (BLUE)

ACCESSORY

PART NO.	DESCRIPTION
25-37	SADDLE FITTING