

TWO-STAGE ADJUSTABLE INJECTOR MODEL 236B, 236BP

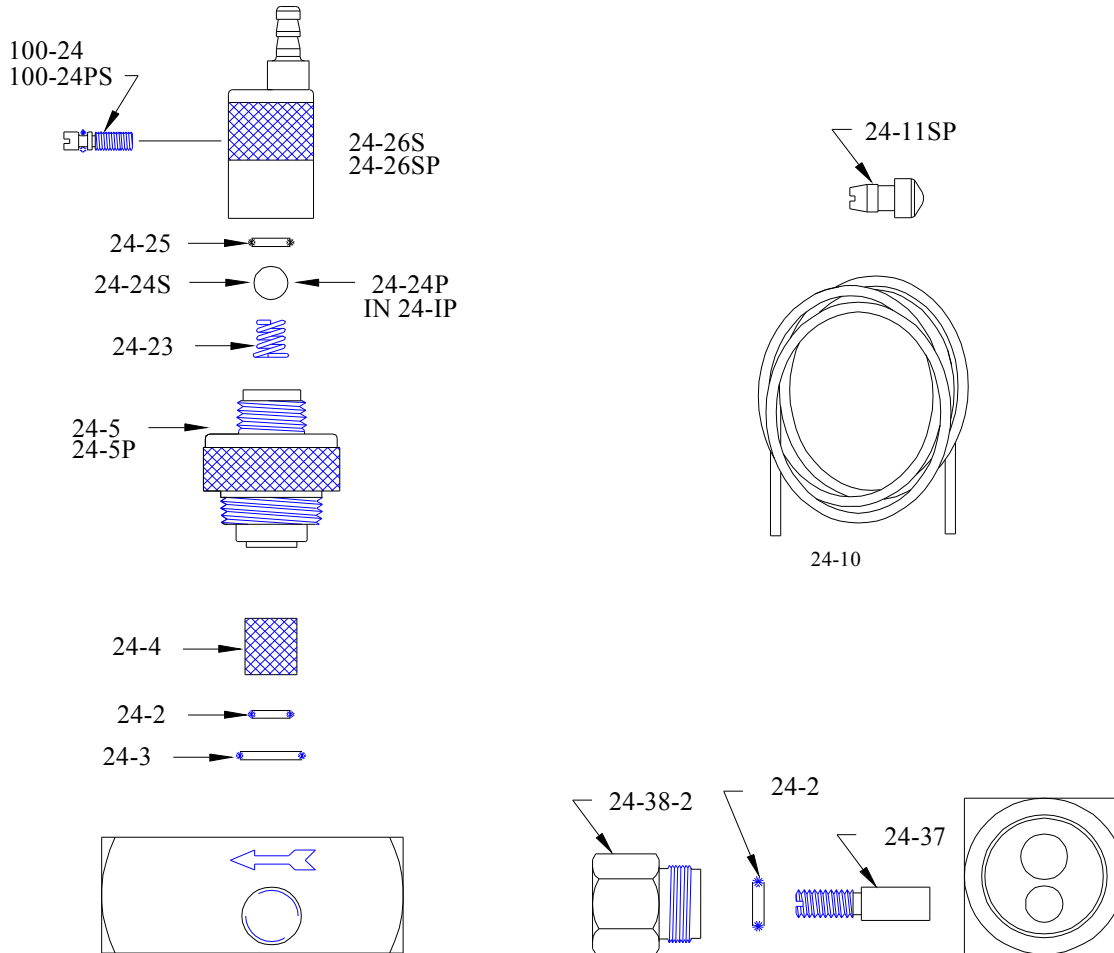

PART NO.	DESCRIPTION	PART NO.	DESCRIPTION
24-1	CAGE ASSEMBLY	24-25	CHECK VALVE O-RING
24-1P	CAGE ASSEMBLY (-P INJECTORS)	24-26S	METERING KNOB, COMPLETE
24-2	CAGE O-RING, SMALL	24-26SP	METERING KNOB (-P INJECTORS)
24-3	CAGE O-RING, LARGE	24-37	BYPASS SCREW
24-4	CAGE SCREEN	24-38-2	BYPASS SCREW RETAINER
24-5	FIRST STAGE VENTURI	100-24	METERING SCREW
24-5P	FIRST-STAGE VENTURI (-P INJECTORS)	100-24PS	METERING SCREW (-P INJECTORS)
24-10	VINYL TUBING (1/2" O.D. X 8' LG.)		
24-11SP	FOOT STRAINER		
24-23	CHECK VALVE SPRING		
24-24P	CHECK VALVE BALL (-P INJECTORS)		
24-24S	CHECK VALVE BALL		