

DEMA SPRAY FOAM MODEL 294CT INSTALLATION INSTRUCTIONS

1. PARTS:

- A. Foamer assembly.
- B. Plastic supply tubing with ceramic weight and strainer.
- C. Outlet hose 3/4" ID x 25' long. (Optional)
- D. Shut off valve. (Optional)

2. INSTALLATION:

- A. Water inlet is 3/4" garden hose swivel.
It may be removed if attaching to 2" pipe.
- B. Air inlet is 1/4" NPT.
Foam outlet is 3/4" garden hose. Connect shutoff valve to end of hose.
- B. See Table 2 for hose limitations.
- D. Detergent may be drawn directly from any size container, which usually is set on the floor. Use the plastic tubing for connecting to the injector barb, first cutting to desired length and dropping the end with the strainer and ceramic weight into the container.

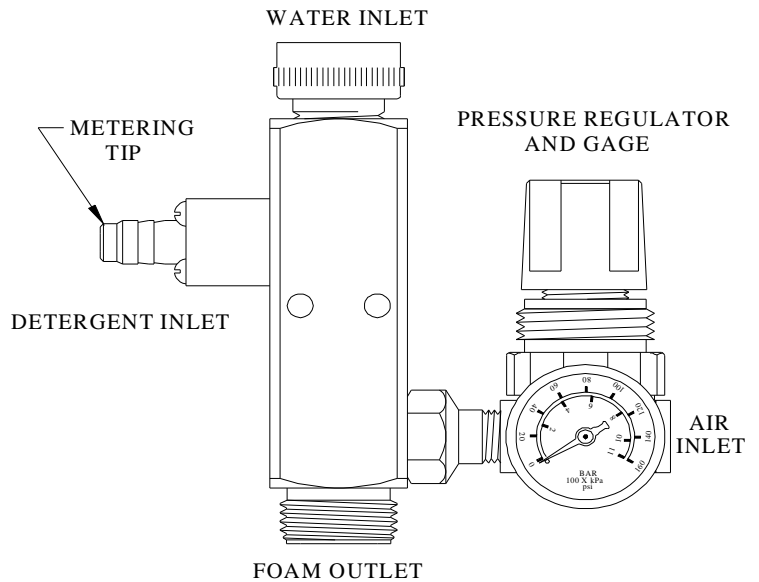

Figure 1

WARNING: Use care when handling hazardous chemicals.

3. OPERATION:

Open shutoff valve at the end of the hose. Turn on the air supply and set the pressure to 40 psi. Turn on the water supply.

4. ADJUSTMENT:

Chemical feed rates are controlled by metering tips screwed into the detergent inlet barb. Select a tip using Table 1 as a guide. Tips are identified by color. Other tips are available from Dema (Part no. 61-9-specify color). To increase dryness of the foam, raise the air pressure by 5 psi. Repeat if necessary. See Table 2 for water and air flow rates.

Hose Size and Length	Min. Pressures	
	Water	Air
25' of 3/4"ID	40 psi	40 psi
50' of 3/4"ID	50 psi	40 psi
25' of 1/2"ID	60 psi	40 psi

Table 2

Metering Tip Color	Injection Rates For Viscosities Shown							
	1 cps		30 cps		75 cps		200 cps	
	Oz/gal	Ratio	Oz/gal	Ratio	Oz/gal	Ratio	Oz/gal	Ratio
Clear	1.25	102:1	0.70	183:1	0.60	213:1	.50	256:1
Purple	2.00	64:1	1.25	102:1	1.10	116:1	1.00	128:1
Yellow	3.00	43:1	2.80	46:1	2.50	51:1	2.20	58:1
Green	5.50	23:1	4.50	28:1	4.20	31:1	3.80	34:1
Pink	6.50	20:1	6.20	21:1	5.50	23:1	4.80	27:1
Turquoise	11.00	12:1	9.00	14:1	8.70	15:1	7.25	18:1
Black	12.50	10:1	10.60	12:1	10.30	12:1	8.60	15:1
Gray	16.20	8:1	14.10	9:1	13.00	10:1	11.00	12:1
Red	20.25	6:1	18.70	7:1	16.30	8:1	13.30	10:1
Blue	24.00	5:1	21.50	6:1	18.60	7:1	14.50	9:1
Brown	29.50	4.3:1	24.50	5:1	21.00	6:1	15.50	8:1
White	33.50	3.8:1	28.50	4.5:1	24.00	5.3:1	16.50	7.8:1
Orange	37.00	3.5:1	30.40	4.2:1	26.00	4.9:1	17.50	7.3:1
No Tip	42.50	3:1	35.00	3.7:1	31.00	4.1:1	20.00	6.4:1

Table 1

DEMA SPRAY FOAM MODEL 294CT INSTALLATION INSTRUCTIONS

5. SERVICING:

CAUTION: Turn off air and water supplies before servicing.

- I. If flow surges and unit fails to make foam:
 - A. Is the metering screw backed off?
 - B. Is the outlet hose too small or too long?
 - C. Is there sufficient water and air pressure? At least 30 psi is required.
 - D. Does the detergent contain a foaming agent?
 - E. Is the foamer outlet attached to a manifold with nozzles too few or too small.

- II. If unit stops operating:
 - A. Is the foot strainer clogged? Lift from drum and clean.
 - B. Is the detergent check valve clogged? Remove the four screws in the square knob. Remove to inspect and clean check valve ball, spring and o-ring.

CAUTION: When servicing be sure that replacement parts have been installed according to the drawing. Be certain that check valve parts are properly in place.

RETURNS: NO MERCHANDISE MAY BE RETURNED FOR CREDIT WITHOUT DEMA'S WRITTEN PERMISSION. RETURN MERCHANDISE AUTHORIZATION NUMBER REQUIRED IN ADVANCE OF RETURN.

WARRANTY: DEMA products are warranted against defective material and workmanship under normal use and service for one year from the date of manufacture. This limited warranty does not apply to any products which have a normal life shorter than one year or failure and damage caused by chemicals, corrosion, improper voltage supply, physical abuse, or misapplication. Rubber and synthetic rubber parts such as "o"-rings, diaphragms, squeeze tubing and gaskets are considered expendable and are not covered under warranty. This warranty is extended only to the original buyer of DEMA products. If products are altered or repaired without prior approval of DEMA, this warranty will be void.

Defective units or parts should be returned to the factory with transportation prepaid. If inspection shows them to be defective, they will be repaired or replaced without charge, F.O.B. factory. DEMA assumes no liability for damages. Return merchandise authorization number, to return units for repair or replacement, must be granted in advance of return.

SPRAY FOAM-MODEL 294CT

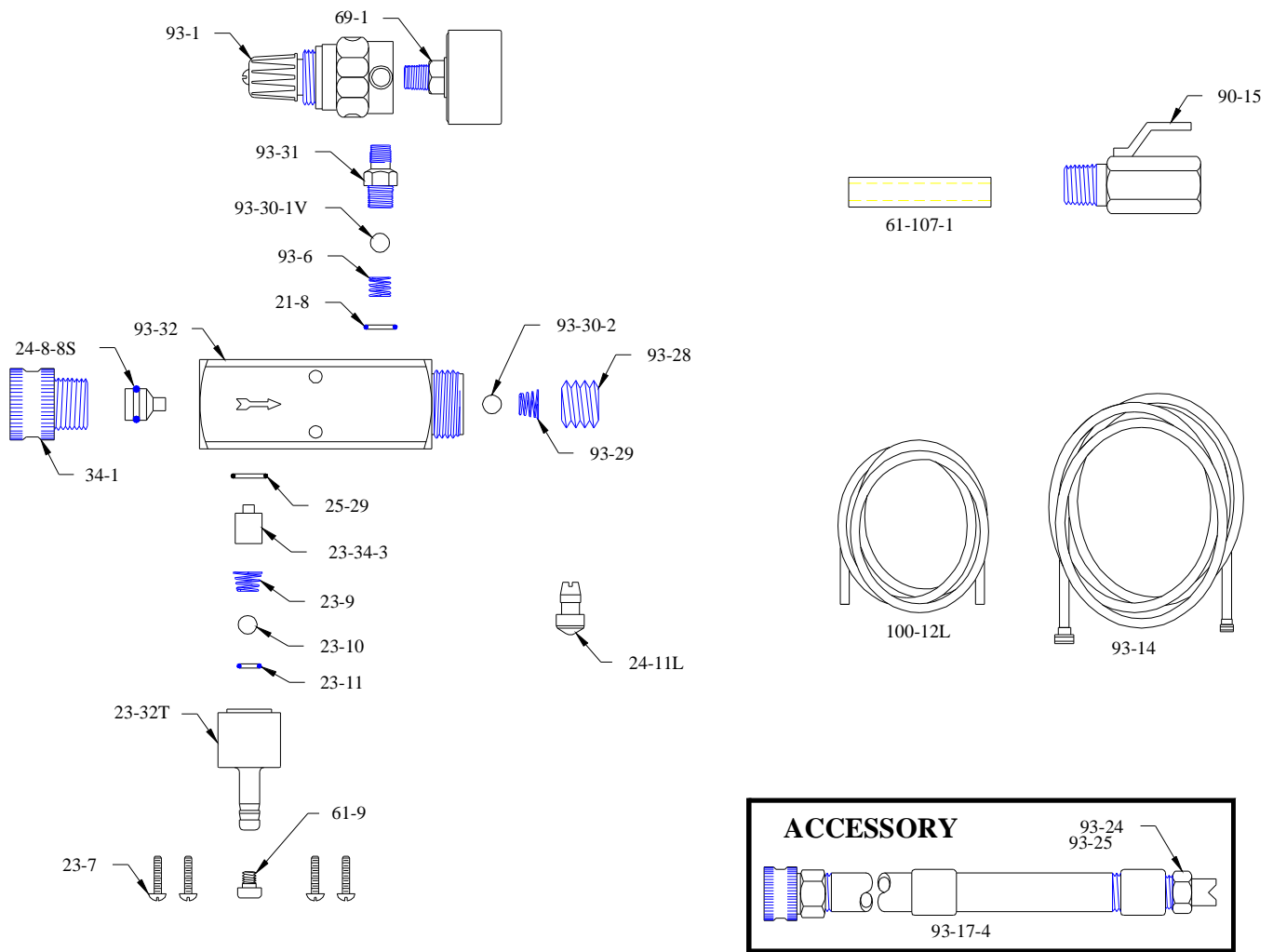

PART NO.	DESCRIPTION
21-8	AIR CHECK VALVE O-RING
23-7	MACHINE SCREW (4 REQD)
23-9	CHECK VALVE SPRING
23-10	CHECK VALVE BALL (9/32 DIA STNLS. STL.)
23-11	CHECK VALVE O-RING
23-32T	METERING KNOB
23-34-3	CHECK VALVE CORE
24-8-8S	WATER NOZZLE W/ O-RING
24-11L	FOOT STRAINER
25-29	METERING KNOB O-RING
34-1	INLET HOSE ADAPTER
61-9	METERING TIP-SPECIFY COLOR
61-107-1	CERAMIC WEIGHT
90-15	OUTLET SHUTOFF VALVE
93-1	PRESSURE REGULATOR
93-2	PRESSURE GAGE

PART NO.	DESCRIPTION
93-6	AIR CHECK VALVE SPRING
93-14	3/4" ID X 25' LG. OUTLET HOSE
93-28	RETAINER SCREW
93-29	SPRING
93-30-1V	BALL (1/4 DIA RUBBER)
93-30-2	BALL 5/16" RUBBER
93-31	ADAPTER
93-32	FOAMER BODY
93-45	SNAP RING
100-12L	1/2" OD VINYL TUBING X 8' LG.

ACCESSORIES

PART NO.	DESCRIPTION
93-17-4	4' LG. SPRAY WAND W/ SOLID STREAM NOZZLE
93-24	NOZZLE W/ SOLID STREAM (SUPPLIED)
93-25	NOZZLE W/ 40° ANGLE