

SUPPLEMENTARY INSTRUCTIONS

- S INJECTORS

Replacement parts for -S (Stainless Steel Knobs) Injectors are as shown:

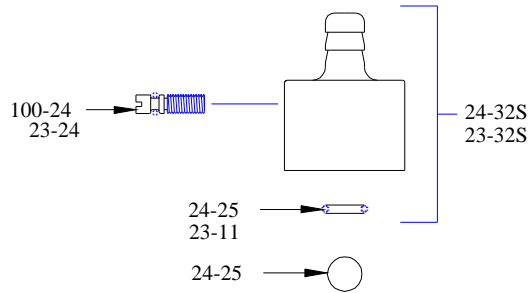

PART NO.	DESCRIPTION
23-10	CHECK VALVE BALL (206C THRU 2012C)
23-11	CHECK VALVE O-RING (206C THRU 2012C)
23-24	METERING SCREW (206C THRU 2012C)
23-32S	METERING KNOB (206C THRU 2012C)
24-24S	CHECK VALVE BALL (200-3C THRU 204C, 202B THRU 206B)
24-25	CHECK VALVE O-RING (200-3C THRU 204C, 202B THRU 206B)
24-32S	METERING KNOB (200-3C THRU 204C, 202B THRU 206B)
100-24	METERING SCREW (200-3C THRU 204C, 202B THRU 206B)

RETURNS:

NO MERCHANDISE MAY BE RETURNED FOR CREDIT WITHOUT DEMA'S WRITTEN PERMISSION. RETURN MERCHANDISE AUTHORIZATION NUMBER REQUIRED IN ADVANCE OF RETURN.

WARRANTY:

DEMA products are warranted against defective material and workmanship under normal use and service for one year from the date of manufacture. This limited warranty does not apply to any products which have a normal life shorter than one year or failure and damage caused by chemicals, corrosion, improper voltage supply, physical abuse, or misapplication. Rubber and synthetic rubber parts such as "o"- rings, diaphragms, squeeze tubing and gaskets are considered expendable and are not covered under warranty. This warranty is extended only to the original buyer of DEMA products. If products are altered or repaired without prior approval of DEMA, this warranty will be void.

Defective units or parts should be returned to the factory with transportation prepaid. If inspection shows them to be defective, they will be repaired or replaced without charge, F.O.B. factory. DEMA assumes no liability for damages. Return merchandise authorization number, to return units for repair or replacement, must be granted in advance of return.