

DEMA 151



FAUCET PROPORTIONER

INSTALLATION INSTRUCTIONS

I. PARTS

- A. Faucet Proportioner
- B. ¼" ID x 8 ft. long vinyl supply tubing, foot valve and ceramic weight
- C. Metering Tips (2 ea.)

II. INSTALLATION

This product is designed only to be used as described in this instruction sheet. Adhere to all warnings and cautions identified in this document.	
	WARNING: Installations must conform to all local and national plumbing codes and use approved backflow prevention and pressure relief devices where required. ALWAYS DISCONNECT DISPENSER FROM WATER SOURCE WHEN DISPENSER IS NOT IN USE.
	Always read SDS for all chemicals used and follow personal protective guidelines.

Screw proportioner directly onto garden hose type faucets. Remove inlet adapters for mounting onto standard external aerator threads. For other faucets, see parts break-down for adapter part numbers. Select a metering tip (See section 4), and screw it into the inlet barb (Figure 1).

Place the chemical container in a convenient location not more than 6 feet below the proportioner (greater lifts will reduce injection capacities). Insert the vinyl supply tubing with the foot end into the chemical container. Cut the vinyl tube to any convenient length that will allow it to extend from the bottom of the chemical container to the proportioner inlet barb. (See Figure 1)

For filling buckets or mop rigs: a short length of open ended garden hose may be attached to the proportioner outlet. Replace screen retainer part 100-8 with hose adapter part 100-10. Use one screen part 100-7 to insure priming.

DEMA 151 FAUCET PROPORTIONER INSTALLATION INSTRUCTIONS

III. OPERATION

WARNING: USE CARE WHEN HANDLING HAZARDOUS CHEMICALS

Turn on water and press the blue button to draw in chemical. When water is turned off, proportioner will reset to dispense clear water.

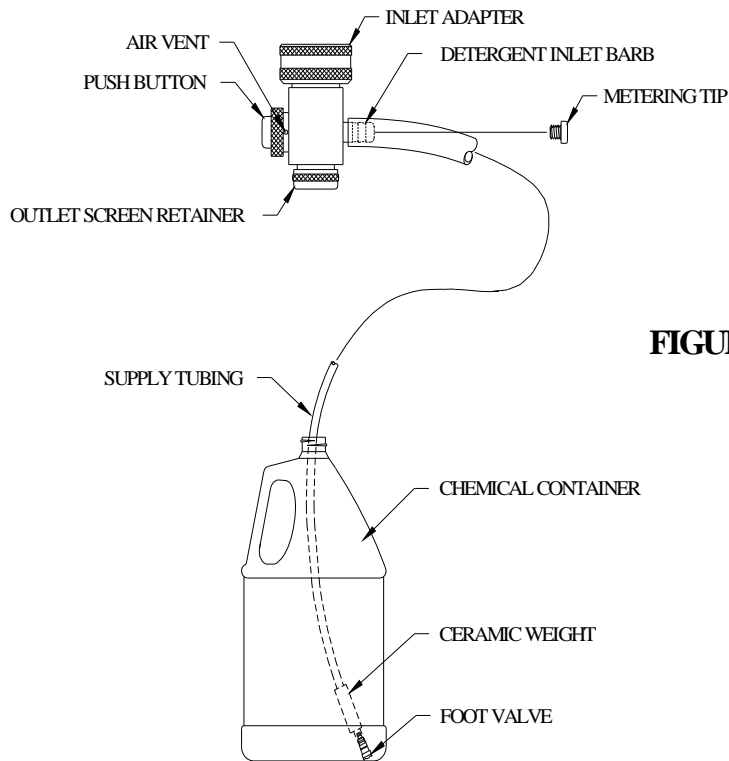

FIGURE 1

DEMA 151

FAUCET PROPORTIONER

INSTALLATION INSTRUCTIONS

IV. CHEMICAL INJECTION ADJUSTMENT

Chemical feed rates are controlled by metering tips screwed into the proportioner barb. Select a tip using the Table as a guide.

Note: 1cp(centipoise) is equivalent to the viscosity of water, 75 cp is approximately equal to the viscosity of 10 weight motor oil, and 200 cp is approximately equal to the viscosity of most dishwashing detergents.

Metering Tip Color	Injection Rates For Viscosities Shown							
	1 cp		2cp		75cp		200 cp	
	Oz./Gal.	Ratio	Oz./Gal.	Ratio	Oz./Gal.	Ratio	Oz./Gal.	Ratio
Tan	0.25	512-1	0.20	640-1	0.17	756-1	0.15	853-1
Orange	0.33	384-1	0.30	427-1	0.25	512-1	0.20	640-1
Turquoise	0.50	256-1	0.40	320-1	0.33	384-1	0.25	512-1
Pink	0.63	205-1	0.50	256-1	0.45	284-1	0.33	384-1
Clear	0.75	171-1	0.70	183-1	0.60	213-1	0.45	284-1
Brown	1.00	128-1	0.85	151-1	0.70	183-1	0.50	256-1
Red	1.25	102-1	1.00	128-1	0.80	160-1	0.60	213-1
White	1.50	85-1	1.25	102-1	1.00	128-1	0.70	183-1
Green	1.75	73-1	1.50	85-1	1.15	111-1	0.75	171-1
Blue	2.00	64-1	1.75	73-1	1.35	95-1	0.85	151-1
Yellow	3.20	40-1	2.50	51-1	1.85	69-1	0.95	135-1
Black	4.00	32-1	3.20	40-1	2.20	58-1	1.00	128-1
Purple	6-40	20-1	5.00	25-1	2.50	51-1	1.05	122-1
Gray	10.00	12-1	5.50	23-1	2.75	47-1	1.07	120-1
No Tip	12.00	10-1	6.40	20-1	3.20	40-1	1.10	116-1

DEMA 151

FAUCET PROPORTIONER INSTALLATION INSTRUCTIONS

V. SERVICING

CAUTION: Turn off water supply before servicing.

A. Failure to inject chemical:

1. Low water pressure. At least 10 psi is required.
2. Dirt or chemical on outlet screens. Clean.
3. Blue button does not seal when pushed. Remove and inspect for dirt or damage.
4. Detergent passage blocked. Remove tip to clean. Remove proportioner and soak in hot water to clean internal passages.
5. Foot valve clogged. Soak in hot water.
6. Lime deposits in water passages. Remove proportioner and soak in a deliming solution.
7. Outlet hose (if used) obstructed or too long.

B. Injects continuously:

1. Button fails to reset because of damage to button, retainer or spring.
2. Vacuum breaking air vents in button retainer are clogged with grease or dirt. Clean.
3. Chemical container above level of faucet. Place container on floor.

CAUTION: When servicing unit, be sure that replacement parts have been installed according to drawing.

RETURNS: NO MERCAHNDISE MAY BE RETURNED FOR CREDIT WITH DEMA'S WRITTEN PERMISSION. RETURN MERCHANDISE AUTHORIZATION NUMBER REQUIRED IN ADVANCE OF RETURN.

WARRANTY: DEMA products are warranted against defective material and workmanship under normal use and service for one year from the date of manufacture. This limited warranty does not apply to any products which have a normal like shorter than one year or failure and damage caused by chemicals, corrosion, improper voltage supply, physical abuse, or misapplication. Rubber and synthetic rubber parts such as "o" rings, diaphragms, squeeze tubing and gaskets are considered expendable and are not covered under warranty. This warranty is extended only to the original buyer of DEMA products. If products are altered or repaired with prior approval of DEMA, this warranty will be void.

Defective units or parts should be returned to the factory with transportation prepaid. If inspection shows them to be defective, they will be repaired or replaced without charge, F.O.B. factory. DEMA assumes no liability for damages. Return merchandise authorization number, to return units for repair or replacement, must be granted in advance of return.

DEMA 151 FAUCET PROPORTIONER INSTALLATION INSTRUCTIONS

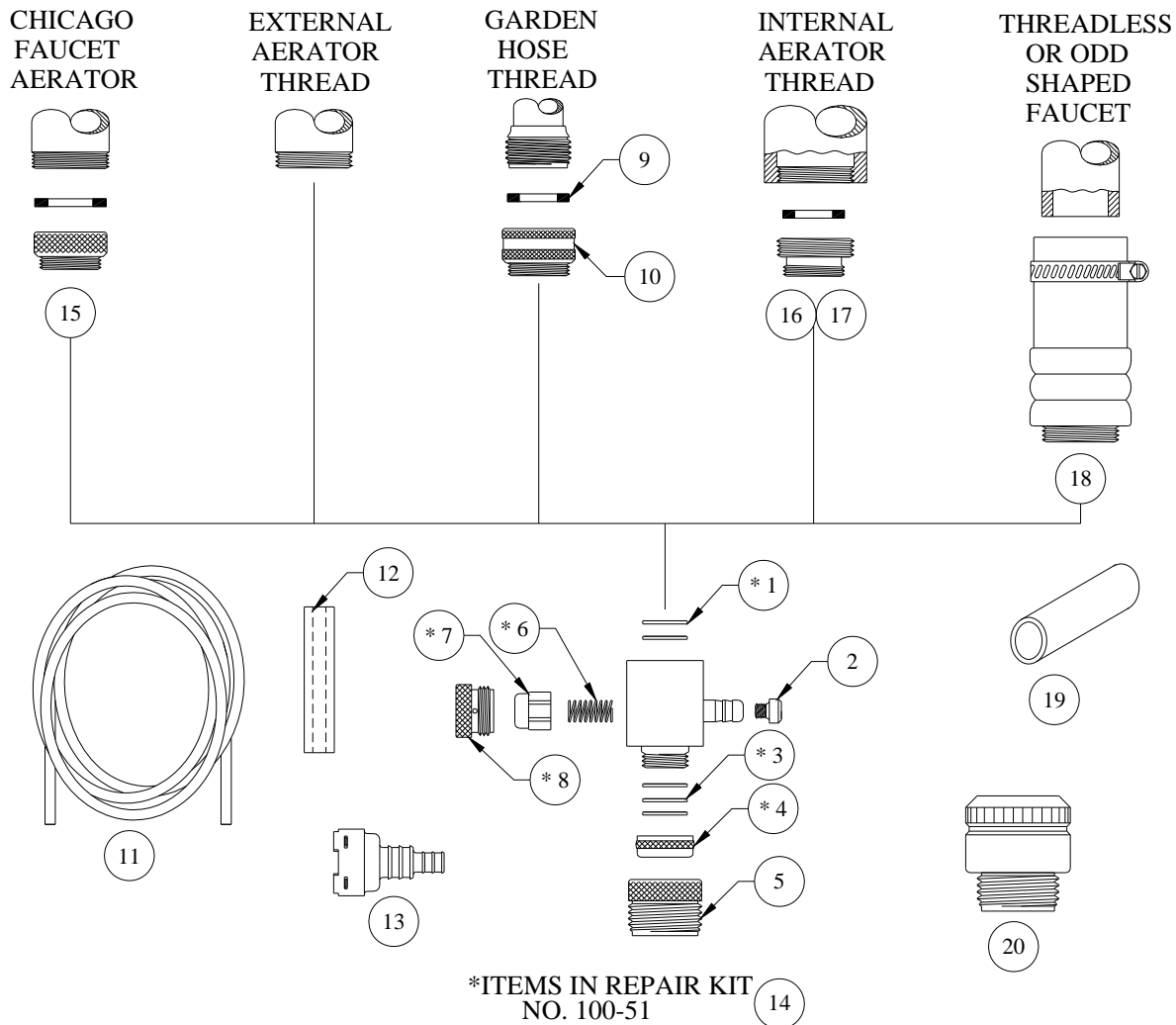

NO.	PART NO.	DESCRIPTION
1 *	100-6	Inlet Washer (2 Reqd.)
2	100-15	Metering Tip (Specify Color)
3 *	100-7	Outlet Screen (3-Reqd.)
4 *	100-8	Outlet Screen Retainer
5	100-10	Outlet Hose Adapter
6 *	100-29	Button Spring
7 *	100-26	Push Button
8 *	100-28	Button Retainer
9	150-6	Adapter Washer
10	150-10	Hose Thread Adapter w/Washer
11	100-12	1/4" ID x 8' Lg. Supply Tubing
12	61-107-2	Ceramic Weight

NO.	PART NO.	DESCRIPTION
13	100-16E	Foot Valve
14	100-51	Repair Kit

NO.	PART NO.	DESCRIPTION
15	150-23	Outside Chicago Thread Adapter
16	150-21	Inside Aerator Thread Adapter
17	150-32	Inside Kohler Thread Adapter
18	150-9-2	Irregular Faucet Adapter
19	100-14M	Coupling For 1/4" ID x 8' Lg. Tubing
20	34-22	Backflow Preventer